

MODEL

COD - Cable Operated Damper, Oval Construction

FEATURES

- Direct cable to damper connection utilizing a 1/4" diameter galvanized steel rotary cable; damper is adjusted via rotary cable actuation using a nut driver
- Cable is routed inside the ductwork and terminated at the diffuser face
- No wall or ceiling penetrations are required
- Available in galvanealed steel in oval sizes to fit Krueger linear slot plenums (DFP, 1900BOOT, and PTB models)
- 8" deep 24 ga. galvanized steel frame with 20 ga. galvanized steel blade
- Cable minimum turn radius = 4"
- Operating temperature limits = -40° to 240°F
- Maximum recommend velocity = 1600 FPM



DIMENSIONAL DATA

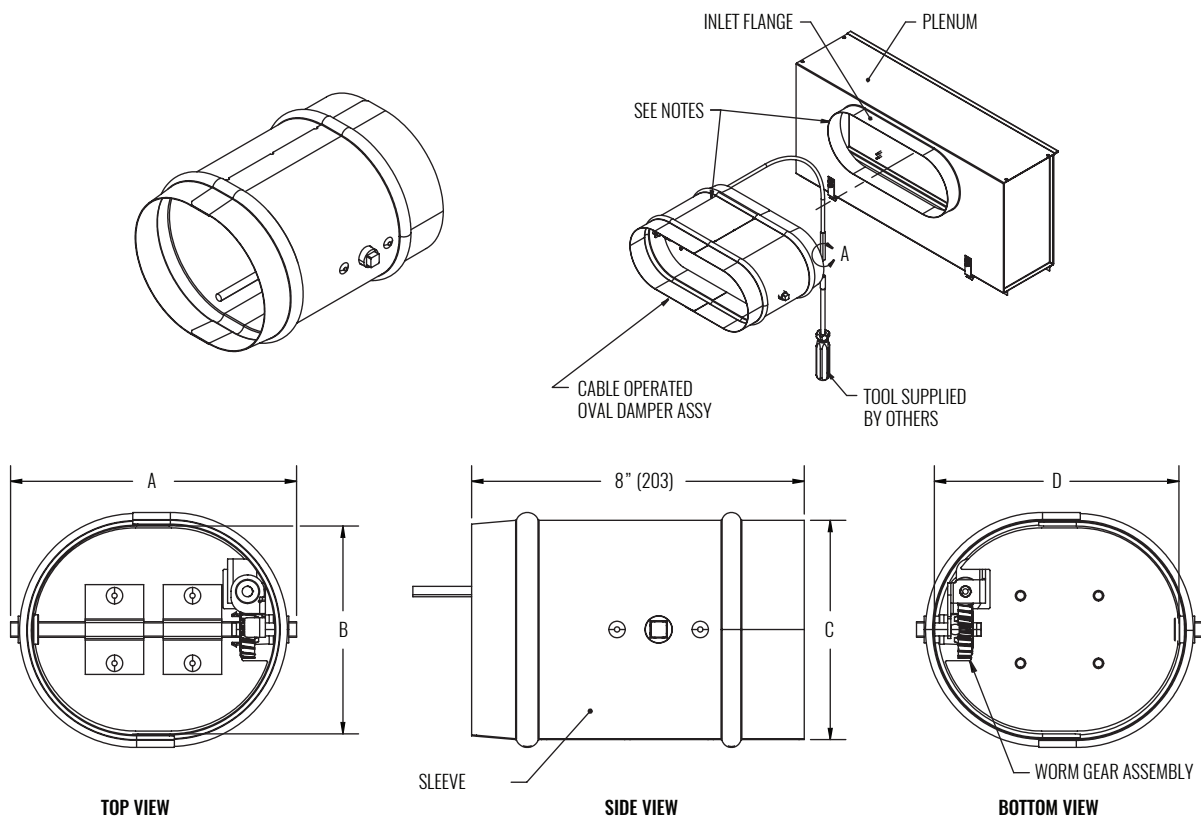

| AVAILABLE SIZES | | | | |
|-----------------|---------------|--------------|--------------|---------------|
| SIZE | A | B | C | D |
| 6" | 6 7/8" (175) | 5" (127) | 5 1/4" (133) | 5 7/8" (149) |
| 8" | 11 1/2" (292) | | | 9 1/8" (232) |
| 10" | 13 1/2" (343) | 7 5/8" (194) | 7 7/8" (200) | 12 1/4" (311) |
| 12" * | 15 1/2" (394) | | | 13 7/8" (352) |

| CABLE LENGTHS |
|---------------|
| 24" (610) |
| 36" (914) |
| 48" (1219) |
| 60" (1524) |
| 72" (1829) |
| 96" (2438) |

NOTE: Cable lengths greater than 24" require field installation of a cable coupler and cable extension.

NOTES: Dimensions in parentheses are mm. *Oval Size 12" does **NOT** fit Krueger's PTB models.