

ABH

Introduction: ABH

The ABH exposed corner mounted chilled beam is great for smaller rooms where the supply air will only be needed in one direction, such as a hotel room or office. This product has several options available to meet different engineering requirements and building needs.

MODEL

ABH - Active Corner Mounted Exposed

FEATURED OPTIONS

(See **STANDARD OPTIONS** on Page C3-17)

- 2 nozzle sizes available.
- Available in lengths from 72" to 196" (4" increments).
- Same side or opposite side of supply air, water coil connections.
- Venting valves for cooling and/or heating coil.
- Custom color matching available.
- Duct cover upon request (32" - 100" in 4" increments).

ABH Dimensional Information

ABH DUCT & SIDE VIEWS

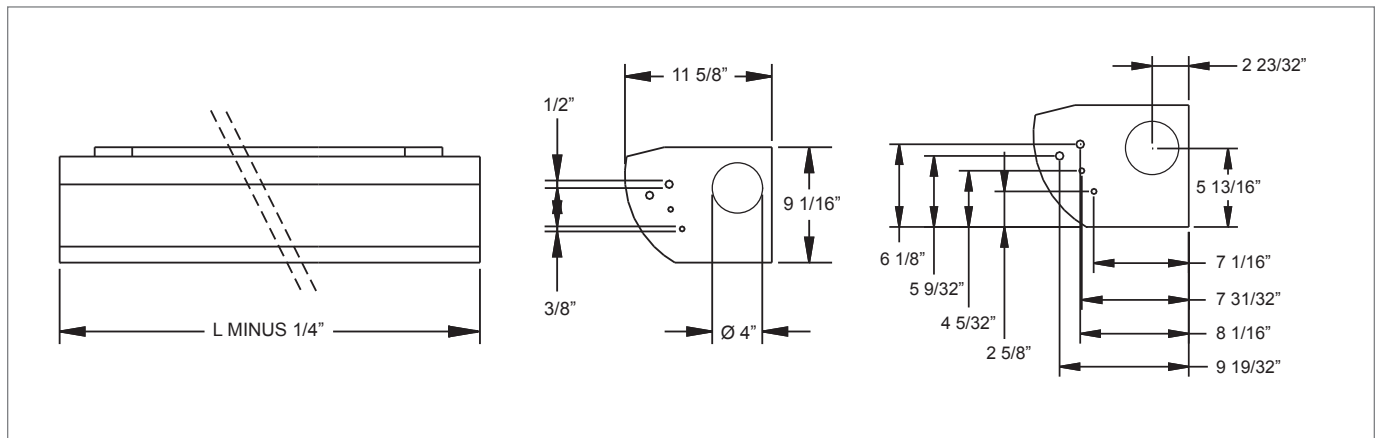

NOTES: All dimensions in inches. Cooling/heating water pipe connections are copper 1/2" and 3/8" with a wall thickness of 0.04". The maximum operating pressure of chilled/hot water pipework is 150 psi.