



RPN
This round punkah nozzle features a surface mounting frame.



CRNRR, 5CRNRR
These concentric ring nozzles feature a stub duct mounting frame for smaller duct work



RPNRD
This round punkah nozzle features a stub duct mounting frame.



CRNP, 5CRNP
These products feature a surface mounting frame with two round concentric ring nozzles.



RPNRR
This round punkah nozzle features a stub duct mounting frame for smaller duct work.



CRNLP, 5CRNLP
This product features a lay-in T-bar frame with one round concentric ring nozzle



RPN2P
This product features a surface mounting frame with two round punkah nozzles.



R580, R5880
These round single and double deflection grilles feature a concealed mounting frame.



RPN4P
This product features a surface mounting frame with four round punkah nozzles.



R580RD, R5880RD
These round single and double deflection grilles feature a round duct adapter frame.



RPNLP
This product features a lay-in T-bar frame with one round punkah nozzle.



R580RR, R5880RR
These round single and double deflection grilles feature a duct reducing mounting frame for smaller duct work.



K-JET
This round jet nozzle mounts to a ceiling tile and supplies a non-adjustable jet of air.



REGC5
These round egg-crate grilles feature a round duct adapter.



K-JET
This round jet nozzle mounts to a ceiling tile and supplies a non-adjustable jet of air.



REGC5RD
These round egg-crate grilles feature a duct reducing mounting frame for smaller duct work.



CRN, 5CRN
These concentric ring nozzles feature a surface mounting frame.



REGC5RR
These round egg-crate grilles feature a duct reducing mounting frame for smaller duct work.



CRNRD, 5CRNRD
These concentric ring nozzles feature a stub duct mounting frame.

RPN Series

Introduction & Dimensional Information....H1-3
Reference Chart & Performance DataH1-8
Engineering Specifications.....H1-10

K-JET, K-JETA

IntroductionH1-12
Dimensional InformationH1-13
Reference Chart H1-13
Performance Data.....H1-14
Engineering Specifications.....H1-16

CRN, 5CRN Series

Introduction & Dimensional Information....H1-17
Reference Chart.....H1-23
Performance Data.....H1-24
Engineering Specifications.....H1-29

R580, R5880 Series

Introduction & Dimensional Information....H1-31
Reference Chart.....H1-34
Performance Data.....H1-35
Engineering Specifications.....H1-39

REGC5 Series

Introduction & Dimensional Information....H1-41
Reference Chart.....H1-44
Performance Data.....H1-45
Engineering Specifications.....H1-49

Introduction: R580, R5880

Designed for surface mount applications, this high capacity series of architectural grilles provide an air stream that can be fully adjusted from a concentrated jet to a robust, widespread air pattern.

MODELS

R580 - Aluminum, Round Single Deflection, Concealed Mount

R5880 - Aluminum, Round Double Deflection, Concealed Mount

FEATURES

- Aluminum construction.
- Round single (R580) or double (R5880) deflection airfoil blade grille with 1" blade spacing.
- Easy finger tip adjustment.
- For use in surface mount applications.
- Flex duct mounting frame available.
- Concealed mounting system standard.

FINISHES

- Standard finish is #70 Silver Metallic.
- Optional finishes available.



R5880 (Face & Side View)



R580, R5880 Dimensional Information

R580, FACE AND SIDE VIEWS

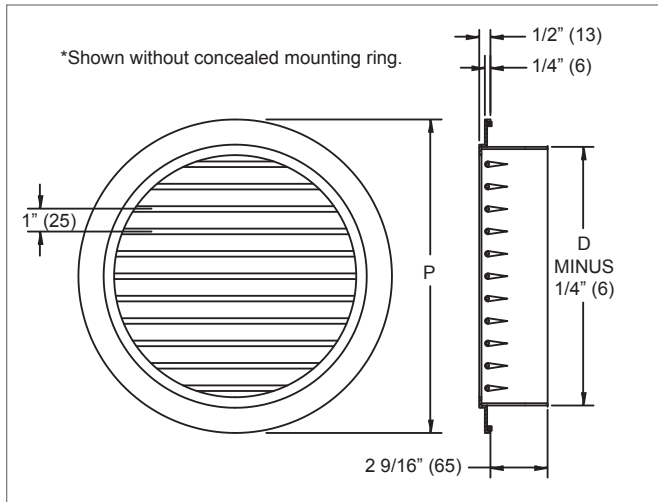

R5880, FACE AND SIDE VIEWS

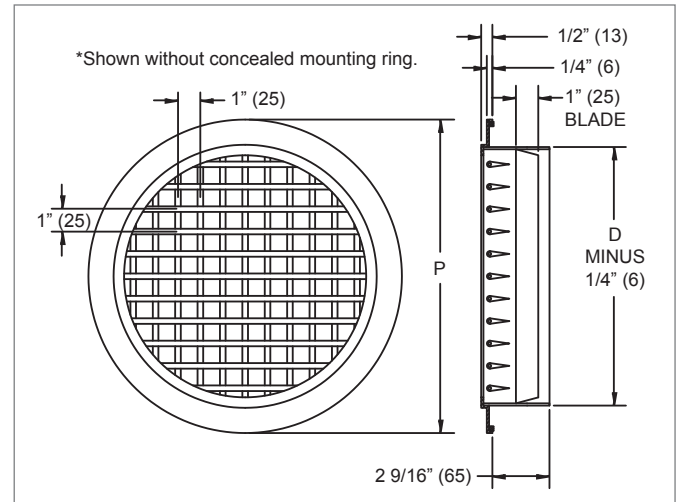

R580, DIMENSIONAL DETAILS

Nominal Size	Duct D	P
6	6" (152)	8 1/4" (210)
8	8" (203)	10 1/4" (260)
10	10" (254)	12 1/4" (311)
12	12" (305)	14 1/4" (362)
14	14" (356)	16 1/4" (413)
16	16" (406)	18 1/4" (464)
18	18" (457)	20 1/4" (514)
20	20" (508)	22 1/4" (565)
22	22" (559)	24 1/4" (616)
24	24" (610)	26 1/4" (667)

R5880, DIMENSIONAL DETAILS

Nominal Size	Duct D	P
6	6" (152)	8 1/4" (210)
8	8" (203)	10 1/4" (260)
10	10" (254)	12 1/4" (311)
12	12" (305)	14 1/4" (362)
14	14" (356)	16 1/4" (413)
16	16" (406)	18 1/4" (464)
18	18" (457)	20 1/4" (514)
20	20" (508)	22 1/4" (565)
22	22" (559)	24 1/4" (616)
24	24" (610)	26 1/4" (667)

NOTE: Dimensions in parentheses are mm.

R580RD, R5880RD | Round Single, Double Deflection

AIR NOZZLES & ROUND GRILLES



R5880RD (Face & Side View)

Introduction: R580RD, R5880RD

Designed to fit cleanly over the end of spiral or round duct work, this high capacity series of grilles feature an integrated round duct adaptor, which works great in exposed duct applications.

MODELS

R580RD - Aluminum, Round Single Deflection, Round Duct Adaptor

R5880RD - Aluminum, Round Double Deflection, Round Duct Adaptor

FEATURES

- Aluminum construction.
- Round single (R580RD) or double (R5880RD) deflection airfoil blade grille with 1" blade spacing.
- Easy finger tip adjustment.
- For use in exposed duct mount applications.
- Frame slides cleanly over end of exposed duct.

FINISHES

- Standard finish is #70 Silver Metallic.
- Optional finishes available.

R580RD, R5880RD Dimensional Information

R580RD, FACE AND SIDE VIEWS

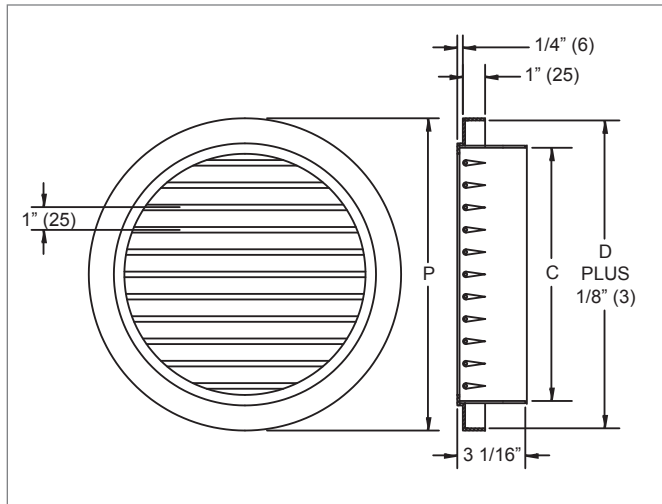

R5880RD, FACE AND SIDE VIEWS

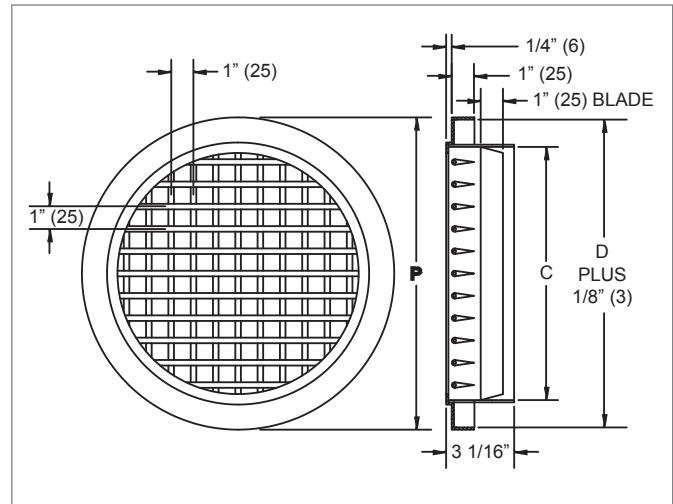

R580RD, DIMENSIONAL DETAILS

Nominal Size *	Core Size C	Duct D	P
6	5 7/8" (149)	8" (203)	8 1/4" (210)
8	7 7/8" (200)	10" (254)	10 1/4" (260)
10	9 7/8" (251)	12" (305)	12 1/4" (311)
12	11 7/8" (302)	14" (356)	14 1/4" (362)
14	13 7/8" (352)	16" (406)	16 1/4" (413)
16	15 7/8" (403)	18" (457)	18 1/4" (464)
18	17 7/8" (454)	20" (508)	20 1/4" (514)
20	19 7/8" (505)	22" (559)	22 1/4" (565)
22	21 7/8" (556)	24" (610)	24 1/4" (616)
24	23 7/8" (606)	26" (660)	26 1/4" (667)

R5880RD, DIMENSIONAL DETAILS

Nominal Size *	Core Size C	Duct D	P
6	5 7/8" (149)	8" (203)	8 1/4" (210)
8	7 7/8" (200)	10" (254)	10 1/4" (260)
10	9 7/8" (251)	12" (305)	12 1/4" (311)
12	11 7/8" (302)	14" (356)	14 1/4" (362)
14	13 7/8" (352)	16" (406)	16 1/4" (413)
16	15 7/8" (403)	18" (457)	18 1/4" (464)
18	17 7/8" (454)	20" (508)	20 1/4" (514)
20	19 7/8" (505)	22" (559)	22 1/4" (565)
22	21 7/8" (556)	24" (610)	24 1/4" (616)
24	23 7/8" (606)	26" (660)	26 1/4" (667)

NOTES: Dimensions in parentheses are mm.

* The nominal size is 2" (51) smaller than the duct size to which it mounts. Example: A size 10 mounts on a 12" (305) duct.

© KRUEGER 2012

Introduction: R580RR, R5880RR

This series of grilles feature an integrated round duct reducer designed to fit cleanly inside the end of spiral or round duct runs, which makes it a great choice for exposed duct applications.

MODELS

R580RR - Aluminum, Round Single Deflection, Round Duct Reducer

R5880RR - Aluminum, Round Double Deflection, Round Duct Reducer

FEATURES

- Aluminum construction.
- Round single (R580RR) or double (R5880RR) deflection airfoil blade grille with 1" blade spacing.
- Easy finger tip adjustment.
- For use in exposed duct mount applications.
- Frame slides cleanly into end of exposed duct.

FINISHES

- Standard finish is #70 Silver Metallic.
- Optional finishes available.

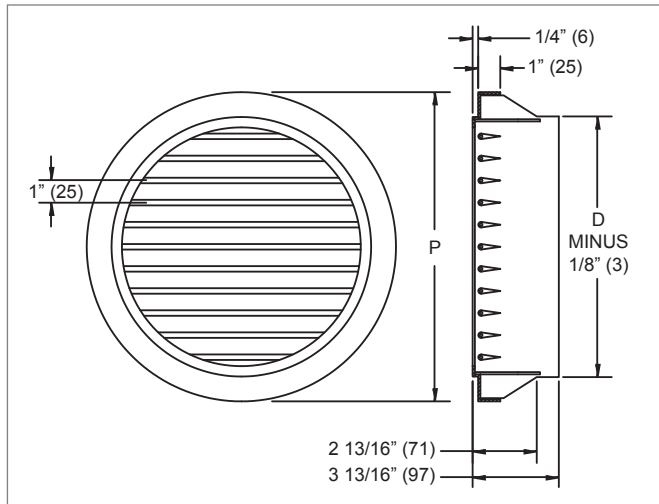
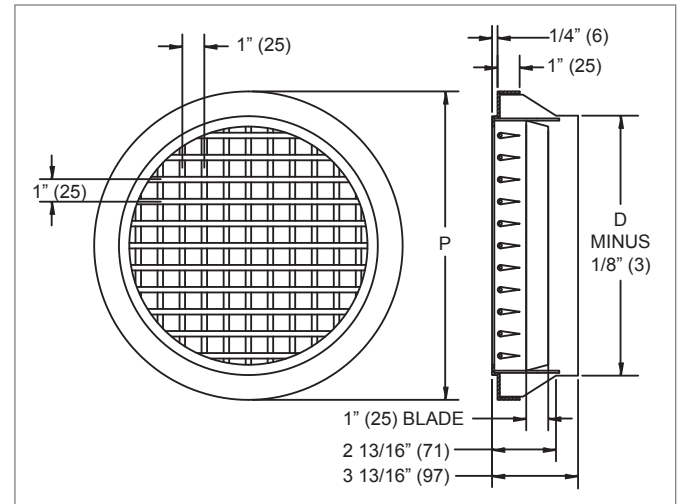

R5880RR (Face & Side View)

R580RR, R5880RR Dimensional Information
R580RR, FACE AND SIDE VIEWS

R5880RR, FACE AND SIDE VIEWS

R580RR, DIMENSIONAL DETAILS

Nominal Size	Duct D	P
6	6" (152)	8 1/4" (210)
8	8" (203)	10 1/4" (260)
10	10" (254)	12 1/4" (311)
12	12" (305)	14 1/4" (362)
14	14" (356)	16 1/4" (413)
16	16" (406)	18 1/4" (464)
18	18" (457)	20 1/4" (514)
20	20" (508)	22 1/4" (565)
22	22" (559)	24 1/4" (616)
24	24" (610)	26 1/4" (667)

R5880RR, DIMENSIONAL DETAILS

Nominal Size	Duct D	P
6	6" (152)	8 1/4" (210)
8	8" (203)	10 1/4" (260)
10	10" (254)	12 1/4" (311)
12	12" (305)	14 1/4" (362)
14	14" (356)	16 1/4" (413)
16	16" (406)	18 1/4" (464)
18	18" (457)	20 1/4" (514)
20	20" (508)	22 1/4" (565)
22	22" (559)	24 1/4" (616)
24	24" (610)	26 1/4" (667)

NOTE: Dimensions in parentheses are mm.

R580, R5880, R580RD, R5880RD, R580RR, R5880RR Series Reference Chart

AIRFLOW VS. NC: R580, R5880, R580RD, R5880RD, R580RR, R5880RR

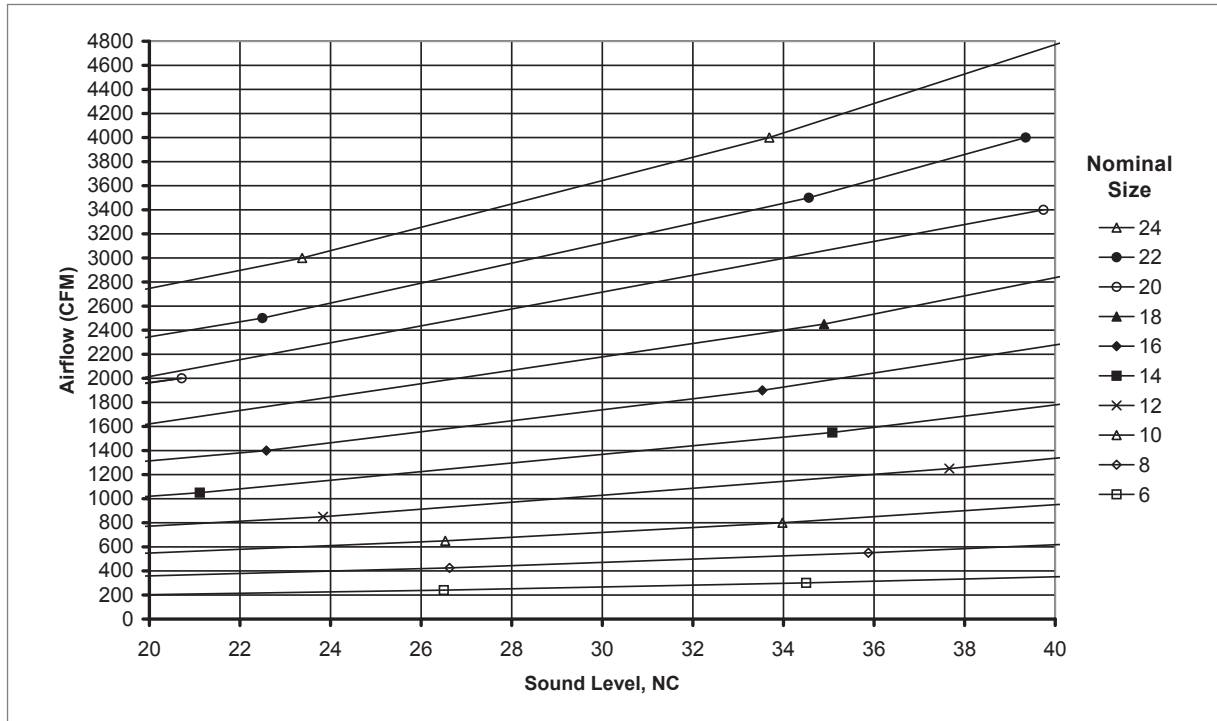

AIR NOZZLES & ROUND GRILLES

5800-1-5800

R580, R580RR, R5880, R5880RR Supply Performance Data
IP DATA: R580, R580RR, R5880, R5880RR

Duct Size	Duct Area	Duct Vel.	Air Flow	0-Degrees		15-Degrees		30-Degrees		NC	Octave Band					
				Pt	Throw	Pt	Throw	Pt	Throw		2	3	4	5	6	7
				in	ft ²	FPM	CFM	"WG	ft		"WG	ft	"WG	ft		
6	0.196	459	90	.037	9 - 13 - 20	.047	8 - 11 - 18	.067	7 - 10 - 16	-	30	20	-	-	-	-
		919	180	.146	16 - 20 - 28	.187	15 - 18 - 25	.269	13 - 16 - 23	16	43	37	32	27	23	14
		1225	240	.260	19 - 23 - 32	.333	17 - 21 - 29	.479	15 - 19 - 26	26	49	44	41	37	34	28
		1531	300	.406	21 - 25 - 36	.520	19 - 23 - 33	.748	17 - 21 - 30	35	53	49	48	45	43	39
		1835	360	.583	23 - 28 - 39	.746	21 - 25 - 36	1.074	19 - 23 - 32	41	57	54	54	51	50	48
8	0.348	502	175	.044	12 - 19 - 28	.056	11 - 16 - 25	.080	9 - 14 - 23	-	33	23	13	-	-	-
		860	300	.128	21 - 25 - 36	.164	18 - 23 - 33	.236	16 - 21 - 30	14	44	36	30	26	20	-
		1218	425	.257	25 - 30 - 43	.329	22 - 27 - 39	.473	20 - 25 - 35	27	50	45	41	38	34	27
		1577	550	.430	28 - 34 - 49	.551	25 - 31 - 44	.793	23 - 28 - 40	36	55	51	50	46	44	40
		1807	630	.565	30 - 37 - 52	.724	27 - 33 - 47	1.041	25 - 30 - 43	41	58	55	54	51	49	47
10	0.545	550	300	.052	17 - 25 - 36	.067	14 - 22 - 33	.097	12 - 19 - 30	-	36	26	17	11	-	-
		872	475	.131	26 - 32 - 45	.168	23 - 29 - 41	.242	20 - 26 - 37	15	45	38	31	27	21	11
		1193	650	.246	31 - 37 - 53	.315	28 - 34 - 48	.454	25 - 31 - 43	27	51	45	41	37	34	26
		1468	800	.373	34 - 42 - 59	.478	31 - 38 - 53	.687	28 - 34 - 48	34	55	51	48	45	42	37
		1835	1000	.583	38 - 47 - 66	.746	34 - 42 - 60	1.074	31 - 38 - 54	42	60	56	55	52	51	48
12	0.785	510	400	.045	18 - 27 - 42	.058	16 - 24 - 38	.083	14 - 20 - 34	-	36	25	15	-	-	-
		796	625	.110	29 - 37 - 52	.141	25 - 33 - 47	.202	21 - 30 - 43	13	44	36	29	24	18	-
		1083	850	.203	35 - 43 - 61	.260	32 - 39 - 55	.374	29 - 35 - 50	24	51	44	39	35	30	22
		1593	1250	.439	42 - 52 - 74	.562	38 - 47 - 67	.809	35 - 43 - 60	38	58	54	52	48	46	41
		1784	1400	.551	45 - 55 - 78	.705	41 - 50 - 70	1.015	37 - 45 - 64	42	60	56	55	52	50	47
14	1.068	562	600	.055	23 - 35 - 51	.070	20 - 30 - 46	.101	17 - 26 - 42	-	39	29	19	13	-	-
		819	875	.116	34 - 44 - 62	.149	29 - 39 - 56	.214	25 - 36 - 50	15	46	38	31	26	20	-
		983	1050	.167	39 - 48 - 67	.214	35 - 43 - 61	.308	30 - 39 - 55	21	50	43	37	32	27	18
		1451	1550	.364	47 - 58 - 82	.467	43 - 52 - 74	.671	39 - 47 - 67	35	57	52	49	46	43	37
		1685	1800	.491	51 - 62 - 88	.629	46 - 56 - 80	.905	42 - 51 - 72	40	60	56	54	51	48	44
16	1.395	538	750	.050	25 - 38 - 57	.064	22 - 33 - 52	.092	19 - 28 - 47	-	39	29	18	12	-	-
		717	1000	.089	34 - 47 - 66	.114	29 - 42 - 60	.164	25 - 38 - 54	11	44	36	28	22	16	-
		1003	1400	.174	45 - 55 - 78	.223	41 - 50 - 70	.321	35 - 45 - 64	23	51	44	38	34	29	19
		1362	1900	.321	52 - 64 - 91	.411	47 - 58 - 82	.591	43 - 53 - 74	34	57	52	48	44	41	34
		1649	2300	.470	58 - 71 - 100	.602	52 - 64 - 90	.867	47 - 58 - 82	40	61	56	54	51	48	44
18	1.766	566	1000	.056	30 - 45 - 66	.071	26 - 38 - 60	.102	22 - 33 - 54	-	41	31	21	15	-	-
		736	1300	.094	39 - 53 - 75	.120	33 - 48 - 68	.173	29 - 43 - 61	12	46	37	29	24	17	-
		906	1600	.142	48 - 59 - 83	.182	41 - 53 - 75	.262	35 - 48 - 68	20	50	42	36	31	25	15
		1387	2450	.333	59 - 73 - 103	.427	54 - 66 - 93	.614	49 - 60 - 84	35	58	53	49	46	42	36
		1699	3000	.500	66 - 81 - 114	.640	60 - 73 - 103	.920	54 - 66 - 93	42	62	58	56	53	50	46
20	2.180	550	1200	.052	32 - 48 - 72	.067	28 - 41 - 65	.097	24 - 36 - 59	-	41	31	21	14	-	-
		734	1600	.093	43 - 59 - 83	.119	37 - 53 - 75	.172	32 - 48 - 68	13	47	38	30	24	18	-
		917	2000	.146	53 - 66 - 93	.187	46 - 60 - 84	.268	40 - 54 - 76	21	51	43	37	32	27	16
		1193	2600	.246	61 - 75 - 106	.315	55 - 68 - 96	.454	50 - 61 - 87	30	56	50	45	41	37	29
		1560	3400	.421	70 - 86 - 121	.539	63 - 78 - 110	.776	57 - 70 - 99	40	61	56	54	50	47	42
22	2.638	569	1500	.056	36 - 54 - 81	.072	31 - 47 - 73	.103	27 - 40 - 66	-	42	32	22	16	-	-
		758	2000	.099	48 - 66 - 93	.127	42 - 60 - 84	.183	36 - 54 - 76	14	48	39	31	26	20	-
		948	2500	.155	60 - 74 - 104	.199	52 - 67 - 94	.286	45 - 60 - 85	22	52	45	39	34	28	18
		1327	3500	.305	71 - 87 - 123	.390	64 - 79 - 111	.561	58 - 71 - 101	35	59	53	49	45	42	35
		1516	4000	.398	76 - 93 - 132	.510	69 - 84 - 119	.733	62 - 76 - 108	39	62	56	54	50	47	41
24	3.139	573	1800	.057	40 - 60 - 88	.073	34 - 51 - 80	.105	30 - 44 - 72	-	43	33	23	17	-	-
		765	2400	.101	53 - 72 - 102	.130	46 - 65 - 92	.186	39 - 59 - 83	15	49	40	32	27	20	-
		956	3000	.158	66 - 81 - 114	.202	57 - 73 - 103	.291	49 - 66 - 93	23	53	46	39	35	29	19
		1274	4000	.281	76 - 93 - 132	.360	69 - 84 - 119	.518	62 - 76 - 108	34	59	53	49	45	41	33
		1529	4800	.405	83 - 102 - 144	.518	75 - 92 - 130	.746	68 - 83 - 118	40	62	57	54	51	48	42

NOTES: NC values are based on octave band 2 - 7 sound power levels minus a room absorption 10dB, re 10⁻¹² Watts. Dash in space denotes a NC value less than 10. Data was obtained from tests conducted in accordance with ANSI/ASHRAE Standard 70. Throw values are given for terminal velocities of 150, 100, and 50 FPM (0.75, 0.50, and 0.25 m/s). Throw data assumes a free jet. For entrained jets, throw increases by approximately 30%.

R580RD, R5880RD Supply Performance Data
IP DATA: R580RD, R5880RD

Duct Size in	Duct Area ft ²	Nom. Size in	Duct Vel. FPM	Air Flow CFM	0-Degrees		15-Degrees		30-Degrees		NC	Octave Band					
					Pt	Throw	Pt	Throw	Pt	Throw		2	3	4	5	6	7
					"WG	ft	"WG	ft	"WG	ft							
8	0.349	6	258	90	.019	9 - 13 - 20	.025	8 - 11 - 18	.035	7 - 10 - 16	-	30	20	-	-	-	-
			517	180	.077	16 - 20 - 28	.098	15 - 18 - 25	.141	13 - 16 - 23	16	43	37	32	27	23	14
			689	240	.136	19 - 23 - 32	.175	17 - 21 - 29	.251	15 - 19 - 26	26	49	44	41	37	34	28
			861	300	.213	21 - 25 - 36	.273	19 - 23 - 33	.393	17 - 21 - 30	35	53	49	48	45	43	39
			1032	360	.306	23 - 28 - 39	.392	21 - 25 - 36	.564	19 - 23 - 32	41	57	54	54	51	50	48
10	0.545	8	321	175	.030	12 - 19 - 28	.038	11 - 16 - 25	.055	9 - 14 - 23	-	33	23	13	-	-	-
			550	300	.087	21 - 25 - 36	.111	18 - 23 - 33	.160	16 - 21 - 30	14	44	36	30	26	20	-
			780	425	.175	25 - 30 - 43	.224	22 - 27 - 39	.322	20 - 25 - 35	27	50	45	41	38	34	27
			1009	550	.293	28 - 34 - 49	.375	25 - 31 - 44	.539	23 - 28 - 40	36	55	51	50	46	44	40
			1156	630	.384	30 - 37 - 52	.492	27 - 33 - 47	.708	25 - 30 - 43	41	58	55	54	51	49	47
12	0.785	10	382	300	.042	17 - 25 - 36	.054	14 - 22 - 33	.077	12 - 19 - 30	-	36	26	17	11	-	-
			605	475	.105	26 - 32 - 45	.135	23 - 29 - 41	.194	20 - 26 - 37	15	45	38	31	27	21	11
			828	650	.197	31 - 37 - 53	.252	28 - 34 - 48	.363	25 - 31 - 43	27	51	45	41	37	34	26
			1019	800	.298	34 - 42 - 59	.382	31 - 38 - 53	.550	28 - 34 - 48	34	55	51	48	45	42	37
			1274	1000	.466	38 - 47 - 66	.597	34 - 42 - 60	.859	31 - 38 - 54	42	60	56	55	52	51	48
14	1.068	12	374	400	.040	18 - 27 - 42	.052	16 - 24 - 38	.074	14 - 20 - 34	-	36	25	15	-	-	-
			585	625	.098	29 - 37 - 52	.126	25 - 33 - 47	.181	21 - 30 - 43	13	44	36	29	24	18	-
			796	850	.182	35 - 43 - 61	.233	32 - 39 - 55	.335	29 - 35 - 50	24	51	44	39	35	30	22
			1170	1250	.393	42 - 52 - 74	.504	38 - 47 - 67	.725	35 - 43 - 60	38	58	54	52	48	46	41
			1311	1400	.493	45 - 55 - 78	.632	41 - 50 - 70	.909	37 - 45 - 64	42	60	56	55	52	50	47
16	1.395	14	430	600	.053	23 - 35 - 51	.068	20 - 30 - 46	.098	17 - 26 - 42	-	39	29	19	13	-	-
			627	875	.113	34 - 44 - 62	.145	29 - 39 - 56	.208	25 - 36 - 50	15	46	38	31	26	20	-
			753	1050	.163	39 - 48 - 67	.208	35 - 43 - 61	.300	30 - 39 - 55	21	50	43	37	32	27	18
			1111	1550	.355	47 - 58 - 82	.454	43 - 52 - 74	.653	39 - 47 - 67	35	57	52	49	46	43	37
			1290	1800	.478	51 - 62 - 88	.612	46 - 56 - 80	.881	42 - 51 - 72	40	60	56	54	51	48	44
18	1.766	16	425	750	.052	25 - 38 - 57	.066	22 - 33 - 52	.095	19 - 28 - 47	-	39	29	18	12	-	-
			566	1000	.092	34 - 47 - 66	.118	29 - 42 - 60	.170	25 - 38 - 54	11	44	36	28	22	16	-
			793	1400	.181	45 - 55 - 78	.231	41 - 50 - 70	.333	35 - 45 - 64	23	51	44	38	34	29	19
			1076	1900	.333	52 - 64 - 91	.426	47 - 58 - 82	.613	43 - 53 - 74	34	57	52	48	44	41	34
			1303	2300	.487	58 - 71 - 100	.624	52 - 64 - 90	.898	47 - 58 - 82	40	61	56	54	51	48	44
20	2.180	18	459	1000	.060	30 - 45 - 66	.077	26 - 38 - 60	.111	22 - 33 - 54	-	41	31	21	15	-	-
			596	1300	.102	39 - 53 - 75	.131	33 - 48 - 68	.188	29 - 43 - 61	12	46	37	29	24	17	-
			734	1600	.155	48 - 59 - 83	.198	41 - 53 - 75	.285	35 - 48 - 68	20	50	42	36	31	25	15
			1124	2450	.363	59 - 73 - 103	.465	54 - 66 - 93	.668	49 - 60 - 84	35	58	53	49	46	42	36
			1376	3000	.544	66 - 81 - 114	.697	60 - 73 - 103	1.002	54 - 66 - 93	42	62	58	56	53	50	46
22	2.638	20	455	1200	.059	32 - 48 - 72	.076	28 - 41 - 65	.110	24 - 36 - 59	-	41	31	21	14	-	-
			607	1600	.106	43 - 59 - 83	.135	37 - 53 - 75	.195	32 - 48 - 68	13	47	38	30	24	18	-
			758	2000	.165	53 - 66 - 93	.212	46 - 60 - 84	.304	40 - 54 - 76	21	51	43	37	32	27	16
			682	1800	.134	48 - 62 - 88	.171	41 - 56 - 80	.246	36 - 51 - 72	17	49	41	34	28	22	11
			1289	3400	.477	70 - 86 - 121	.611	63 - 78 - 110	.879	57 - 70 - 99	40	61	56	54	50	47	42
24	3.139	22	478	1500	.066	36 - 54 - 81	.084	31 - 47 - 73	.121	27 - 40 - 66	-	42	32	22	16	-	-
			637	2000	.117	48 - 66 - 93	.149	42 - 60 - 84	.215	36 - 54 - 76	14	48	39	31	26	20	-
			796	2500	.182	60 - 74 - 104	.233	52 - 67 - 94	.336	45 - 60 - 85	22	52	45	39	34	28	18
			1115	3500	.357	71 - 87 - 123	.457	64 - 79 - 111	.658	58 - 71 - 101	35	59	53	49	45	42	35
			1274	4000	.466	76 - 93 - 132	.597	69 - 84 - 119	.859	62 - 76 - 108	39	62	56	54	50	47	41
26	3.684	24	489	1800	.069	40 - 60 - 88	.088	34 - 51 - 80	.126	30 - 44 - 72	-	43	33	23	17	-	-
			651	2400	.122	53 - 72 - 102	.156	46 - 65 - 92	.225	39 - 59 - 83	15	49	40	32	27	20	-
			814	3000	.190	66 - 81 - 114	.244	57 - 73 - 103	.351	49 - 66 - 93	23	53	46	39	35	29	19
			1086	4000	.339	76 - 93 - 132	.434	69 - 84 - 119	.624	62 - 76 - 108	34	59	53	49	45	41	33
			1303	4800	.488	83 - 102 - 144	.625	75 - 92 - 130	.898	68 - 83 - 118	40	62	57	54	51	48	42

NOTES: NC values are based on octave band 2 - 7 sound power levels minus a room absorption 10dB, re 10⁻¹² Watts. Dash in space denotes a NC value less than 10. Data was obtained from tests conducted in accordance with ANSI/ASHRAE Standard 70. Throw values are given for terminal velocities of 150, 100, and 50 FPM (0.75, 0.50, and 0.25 m/s). Throw data assumes a free jet. For entrained jets, throw increases by approximately 30%.

R580, R580RD, R580RR Suggested Specification & Configuration
1. SERIES: (XXXXXX)

- R580 - Aluminum, Round Single Deflection, Concealed Mount
- R580RD - Aluminum, Round Single Deflection, Round Duct Adaptor
- R580RR - Aluminum, Round Single Deflection, Round Duct Reducer

2. SIZE: (XX) *

- 06 - 6" Unit Size
- 08 - 8" Unit Size
- 10 - 10" Unit Size
- 12 - 12" Unit Size
- 14 - 14" Unit Size
- 16 - 16" Unit Size
- 18 - 18" Unit Size
- 20 - 20" Unit Size
- 22 - 22" Unit Size
- 24 - 24" Unit Size

3. FINISH: (XX)

- 01 - Mill
- 36 - Black
- 44 - British White
- 50 - Bright White
- 61 - Gray Prime
- 70 - Silver Metallic
- 99 - Custom Color

* Unit and duct sizes are not the same for model R580RD.

R580

The single deflection round supply grille shall be a Krueger model R580. This grille must have individually adjustable blades on 1" centers with friction pivots made of extruded aluminum with an airfoil shape and have a maximum thickness of .2275" and a minimum thickness of no less than .0625". The flange of the R580 shall be made of aluminum and have a minimum thickness of .072". A foam gasket on the reverse side of the flange shall be provided by the manufacturer. The single deflection round supply grille shall have a concealed mounting system that includes a separate duct mounting ring. Screw holes on the face of the unit are not acceptable.

R580RD

The single deflection round supply grille shall be a Krueger model R580RD. This grille must have individually adjustable blades on 1" centers with friction pivots made of extruded aluminum with an airfoil shape and have a maximum thickness of .2275" and a minimum thickness of no less than .0625". The flange of the R580RD shall be made of aluminum and have a minimum thickness of .072". The single deflection round supply grille shall slide cleanly over the end of exposed duct work and be secured with screws provided by the manufacturer. The screws shall mount to the side of the grille. Screw holes on the face of the unit are not acceptable.

R580RR

The single deflection round supply grille shall be a Krueger model R580RR. This grille must have individually adjustable blades on 1" centers with friction pivots made of extruded aluminum with an airfoil shape and have a maximum thickness of .2275" and a minimum thickness of no less than .0625". The flange of the R580RR shall be made of aluminum and have a minimum thickness of .072". The single deflection round supply grille shall slide cleanly into end of exposed duct work and be secured with screws provided by the manufacturer. The screws shall mount to the side of the grille. Screw holes on the face of the unit are not acceptable.

PERFORMANCE

The manufacturer shall provide published performance data for the grille. The grille shall be tested in accordance to the data standards at the time of product introduction or ANSI/ASHRAE Standard 70.

FINISH

The paint finish shall be #70 Silver Metallic and be a P-Series Powder Coating finish, baked at 400°F for 7 minutes. The paint thickness shall be 1.8 – 2.2 mils, pencil hardness per ASTM D3363 of H – 2H, crosshatch adhesion per ASTM D3359 of 4B, impact per ASTM D2794 of direct and reverse impact range of 40 to 160 in/lb depending on formulation, salt spray per ASTM B117 of 1000 hours, humidity per ASTM D2247 of 1000 hours and water soak per ASTM D8702 of 500 hours.

R5880, R5880RD, R5880RR Suggested Specification & Configuration

R5880

The double deflection round supply grille shall be a Krueger model R5880. This grille must have individually adjustable blades on 1" centers with friction pivots made of extruded aluminum with an airfoil shape and have a maximum thickness of .2275" and a minimum thickness of no less than .0625". The flange of the R5880 shall be made of aluminum and have a minimum thickness of .072". A foam gasket on the reverse side of the flange shall be provided by the manufacturer. The double deflection round supply grille shall have a concealed mounting system that includes a separate duct mounting ring. Screw holes on the face of the unit are not acceptable.

R5880RD

The double deflection round supply grille shall be a Krueger model R5880RD. This grille must have individually adjustable blades on 1" centers with friction pivots made of extruded aluminum with an airfoil shape and have a maximum thickness of .2275" and a minimum thickness of no less than .0625". The flange of the R5880RD shall be made of aluminum and have a minimum thickness of .072". The double deflection round supply grille shall slide cleanly over the end of exposed duct work and be secured with screws provided by the manufacturer. The screws shall mount to the side of the grille. Screw holes on the face of the unit are not acceptable.

R5880RR

The double deflection round supply grille shall be a Krueger model R5880RR. This grille must have individually adjustable blades on 1" centers with friction pivots made of extruded aluminum with an airfoil shape and have a maximum thickness of .2275" and a minimum thickness of no less than .0625". The flange of the R5880RR shall be made of aluminum and have a minimum thickness of .072". The double deflection round supply grille shall slide cleanly into end of exposed duct work and be secured with screws provided by the manufacturer. The screws shall mount to the side of the grille. Screw holes on the face of the unit are not acceptable.

PERFORMANCE

The manufacturer shall provide published performance data for the grille. The grille shall be tested in accordance to the data standards at the time of product introduction or ANSI/ASHRAE Standard 70.

FINISH

The paint finish shall be #70 Silver Metallic and be a P-Series Powder Coating finish, baked at 400°F for 7 minutes. The paint thickness shall be 1.8 – 2.2 mils, pencil hardness per ASTM D3363 of H – 2H, crosshatch adhesion per ASTM D3359 of 4B, impact per ASTM D2794 of direct and reverse impact range of 40 to 160 in/lb depending on formulation, salt spray per ASTM B117 of 1000 hours, humidity per ASTM D2247 of 1000 hours and water soak per ASTM D8702 of 500 hours.

1. SERIES: (XXXXXXX)

- R5880 - Aluminum, Round Double Deflection, Concealed Mount
- R5880RD - Aluminum, Round Double Deflection, Round Duct Adaptor
- R5880RR - Aluminum, Round Double Deflection, Round Duct Reducer

2. SIZE: (XX) *

- 06 - 6" Unit Size
- 08 - 8" Unit Size
- 10 - 10" Unit Size
- 12 - 12" Unit Size
- 14 - 14" Unit Size
- 16 - 16" Unit Size
- 18 - 18" Unit Size
- 20 - 20" Unit Size
- 22 - 22" Unit Size
- 24 - 24" Unit Size

3. FINISH: (XX)

- 01 - Mill
- 36 - Black
- 44 - British White
- 50 - Bright White
- 61 - Gray Prime
- 70 - Silver Metallic
- 99 - Custom Color

* Unit and duct sizes are not the same for model R5880RD.

SAMPLE CONFIGURATION: R5880 - 10 - 44