

800, 5800 Dimensional Information

800, 5800, FACE VIEW, SIDE VIEW, & CROSS SECTION

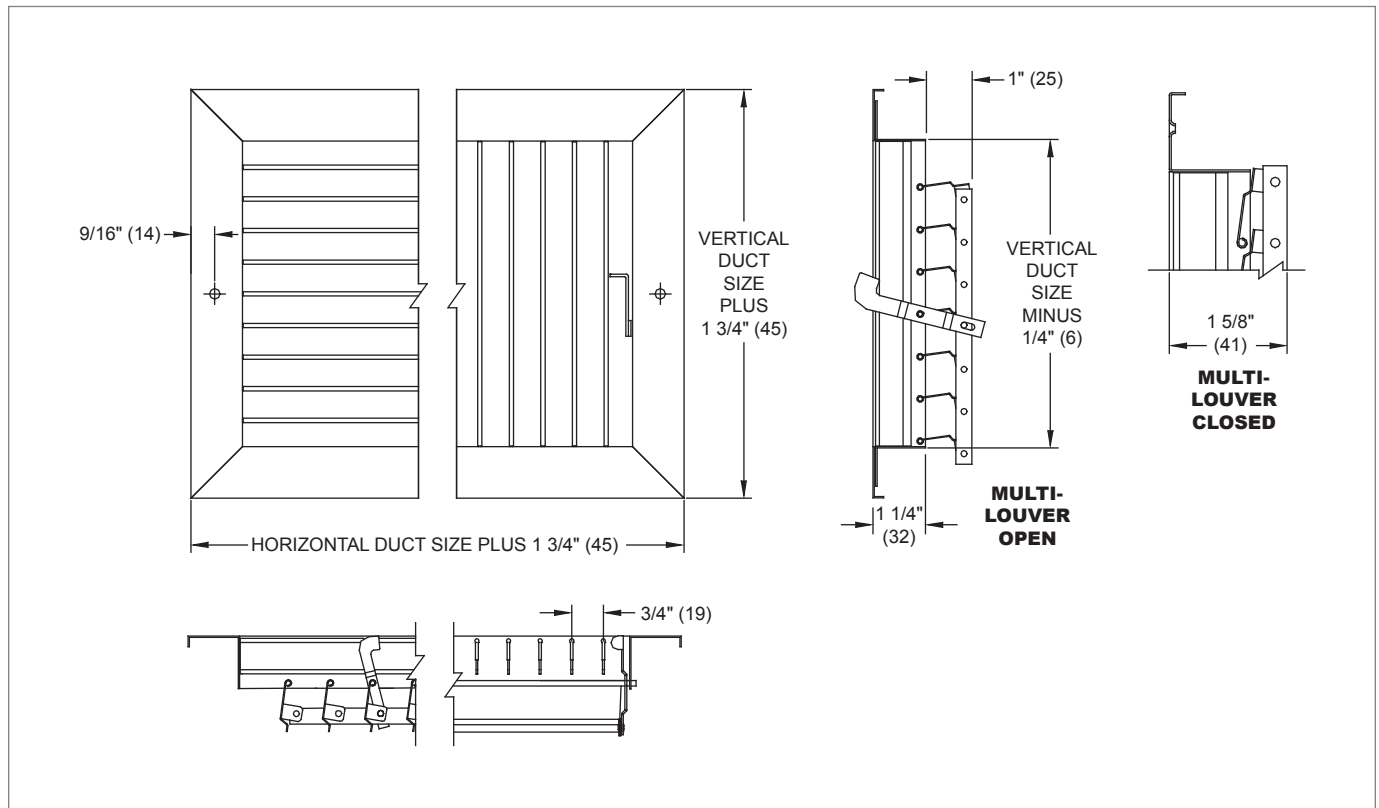

880, 4880, 800 Series Frame Styles & Concealed Mounting

80, 580, 880, 5880, 585, 5885, 480, 4880, 800, 5800, FRAME STYLES

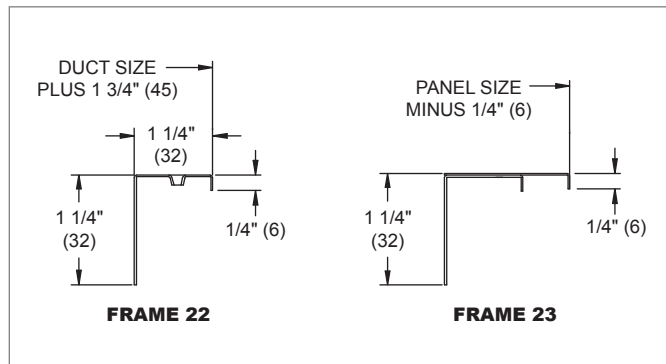

NOTES: Dimensions in parentheses are mm. Frame 23 is not available with the 480/4880 series.

80, 580, 880, 5880, 585, 5885, 480, 4880, CONCEALED MOUNTING

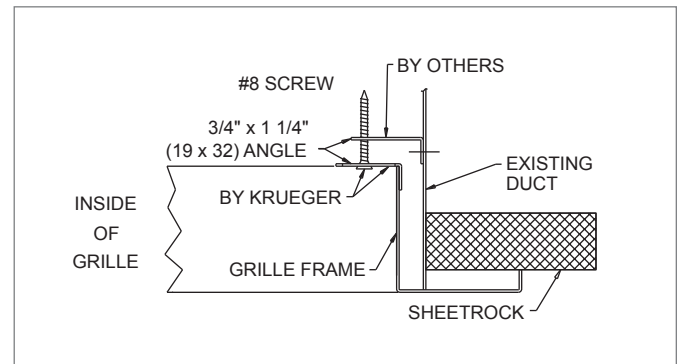

NOTES: Concealed mounting is not available with an OBD or with the 800/5800 series. Maximum unit size is 36"x20".