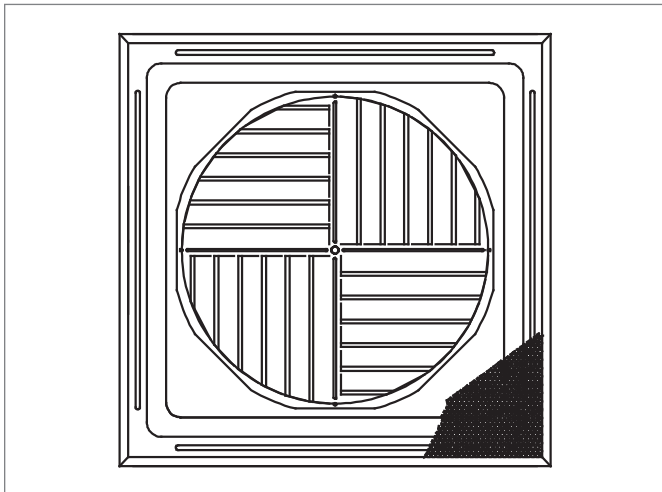
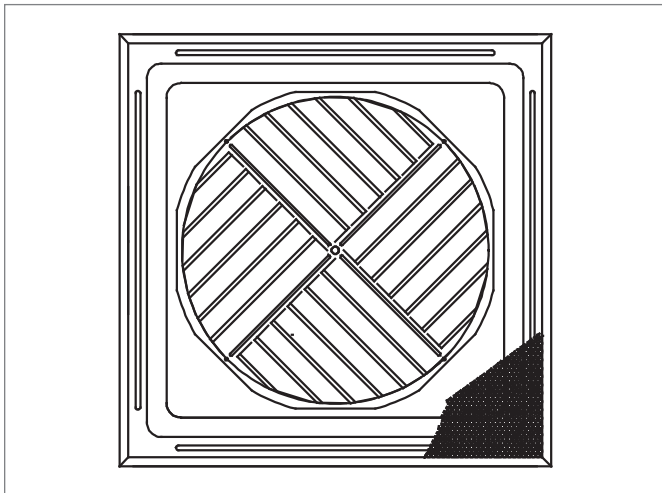

6100

6100, 56100, 6150, 56150**Discharge Air Patterns****6100, 6150 SERIES, STANDARD DISCHARGE PATTERN****6100, 6150 SERIES, CORNER DISCHARGE PATTERN****Introduction: 6100, 56100, 6150, 56150**

The 6100/6150 series perforated diffusers feature a unique, self-centering stamped core that rotates 45° for easy adjustment from cross flow to corner flow. The core is designed to maintain the set discharge air pattern while the individual blades may be easily adjusted if desired. The stamped curved blade core delivers pleasing aesthetics with a circle-in-square design and performance with typical isothermal throws of 8' - 17'. This design makes Krueger's 6100/6150 series diffuser an ideal choice for modular office spaces where room airflow patterns can be adjusted according to cubicle layout.

MODELS

- 6100 - Steel Construction, Round Neck, Perforated Supply Diffuser
- 6150 - Steel Construction, Square Neck, Perforated Supply Diffuser
- 56100 - Aluminum Perforation with Steel Backpan, Round Neck, Perforated Supply Diffuser
- 56150 - Aluminum Perforation with Steel Backpan, Square Neck, Perforated Supply Diffuser

FEATURES

- Unique self-centering stamped core; rotates 45° for easy adjustment from standard to corner discharge air patterns.
- Circle-in-square design enhances decor and blends with most ceiling tiles.
- Removable perforated face and core for ease of cleaning.
- Individually adjustable blades to maintain optimal performance positions.

PANEL SIZES

- 24"x24"

ACCESSORIES

- Optional Round Damper
- Optional Opposed Blade Damper (Model OBD)

FINISHES

- Standard finish is #44 British White.
- Optional finishes available.

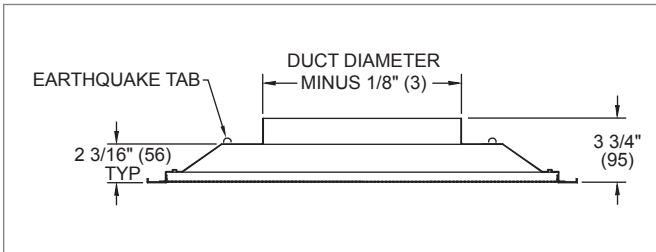
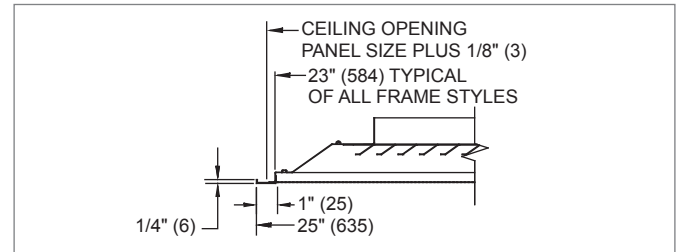
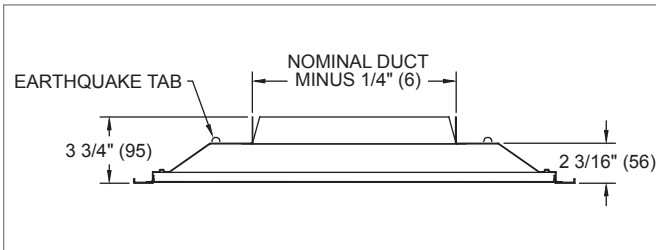
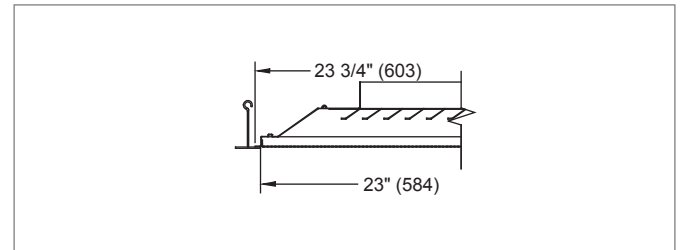
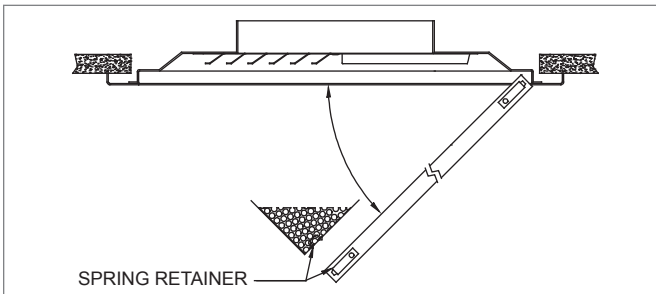
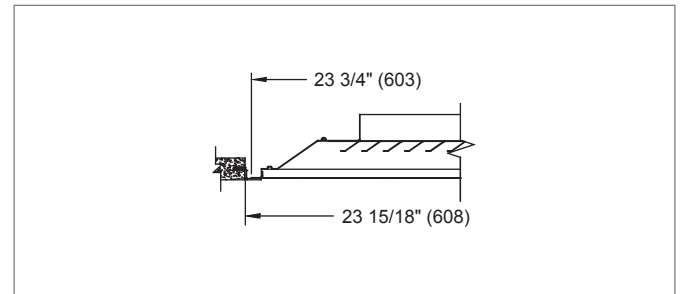
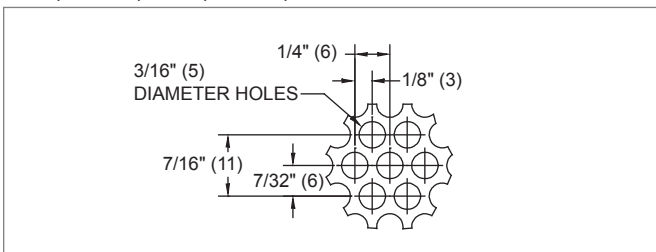
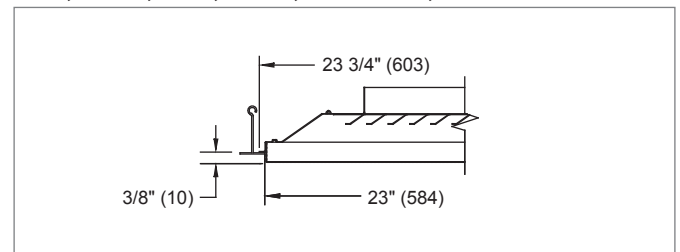
6100, 56100, 6150, 56150 (Supply) Dimensional Information & Frame Styles
6100, 56100, SIDE VIEW (ROUND NECK)

6100, 56100, 6150, 56150, FRAME 20, SURFACE MOUNT

6150, 56150, SIDE VIEW (SQUARE NECK)

6100, 56100, 6150, 56150, FRAME 23, LAY-IN T-BAR

6100, 56100, 6150, 56150, HINGE DETAIL

6100, 56100, 6150, 56150, FRAME 27, SPLINE

6100, 56100, 6150, 56150, PERFORATION DETAIL

6100, 56100, 6150, 56150, FRAME 30, DROP FACE

6100, 56100, 6150, 56150, AVAILABLE SIZES

24" x 24" (610 x 610) Panel	
6100/56100 - Round	6150/56150 - Square
6" (152)	6"x6" (152x152)
8" (203)	8"x8" (203x203)
10" (254)	10"x10" (254x254)
12" (305)	-
14" (356)	-
15" (381)	-

NOTES: Dimensions in parentheses are mm.
 Dash indicates not applicable.

6100, 56100, 6150, 56150, FRAME 98, NARROW-T
