

## 6600FR (Fire Rated Supply) Dimensional Information

The 6600FR offers the safety of fire rated performance with the proven 6600 series diffuser. It is intended for use with Lay-in T-Bar application involving fire rated ceiling designs. It combines this flexibility with all of the features of the standard 6600 and is available exclusively in steel.

6600FR comes standard as a UL 263 classified assembly which incorporates a 3-hour rated fire damper and a 1/2" thick ceramic fiber blanket.



**6600FR, SUPPLY FACE VIEW (24"x24" PANEL)**

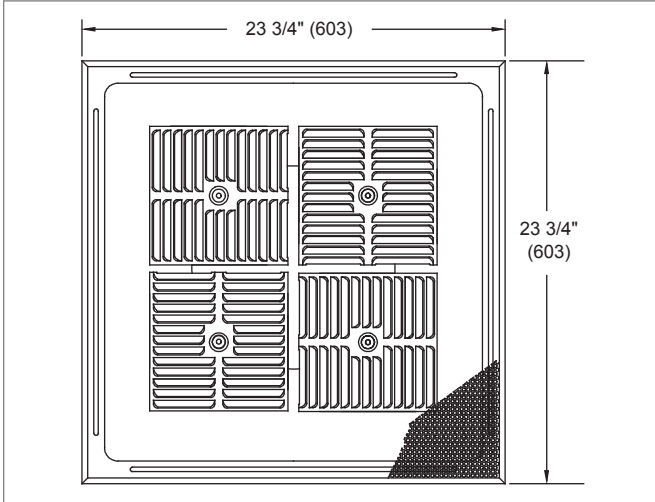

**6600FR, HINGE DETAIL**

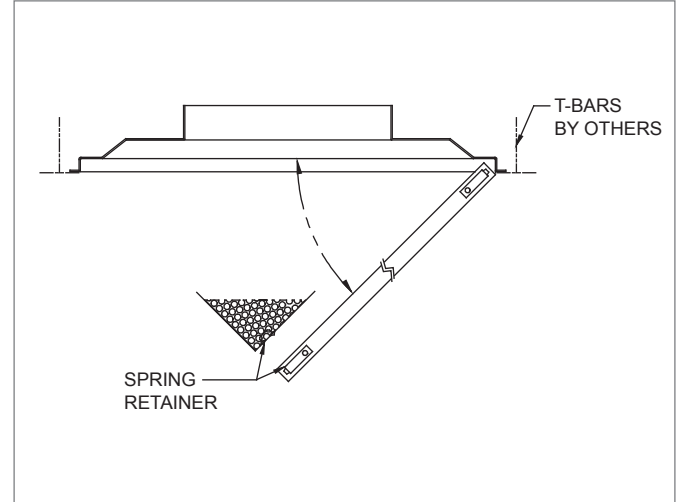

**6600FR, CROSS SECTION**

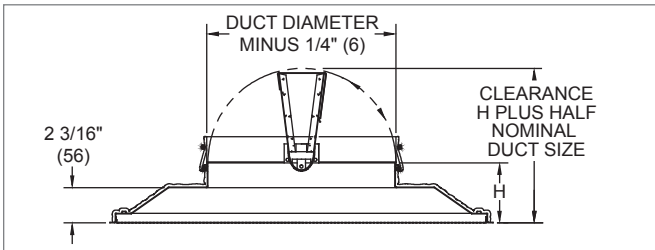

**6600FR, FIRE BLANKET DETAIL**

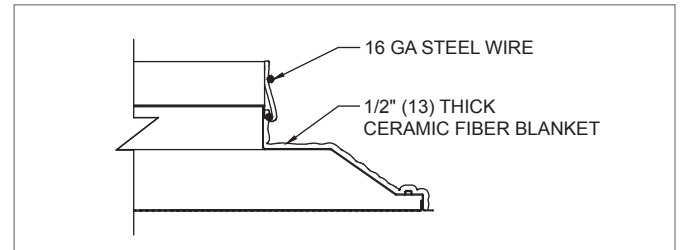

**6600FR, PERFORATION DETAIL**

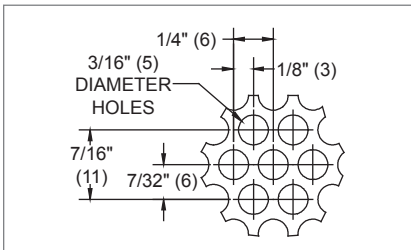

**6600FR, DISCHARGE AIR PATTERNS**

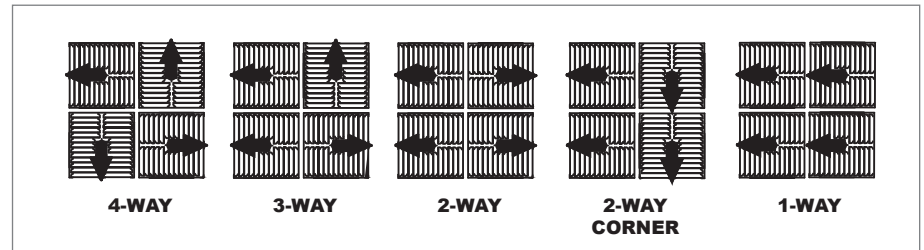

**6600FR, AVAILABLE INLET SIZES**

	INLET SIZES	H
<b>NOMINAL PANEL</b> <b>24" x 24"</b> <b>(610 x 610)</b>	6" (152)	3 1/4" (83)
	8" (203)	
	10" (254)	
	12" (305)	3 3/4" (95)
	14" (356)	

NOTE: Dimensions in parentheses are mm.