

JOB NAME _____
 ARCHITECT _____
 ENGINEER _____
 CONTRACTOR _____
 LOCATION _____

SUBMITTAL SHEET
 Form Number SG7016.3 Effective Date 10/12
 Replaces FORM SG7016.1



1310 Security Series
Steel Supply or Return Grille

Round Perforated Pattern

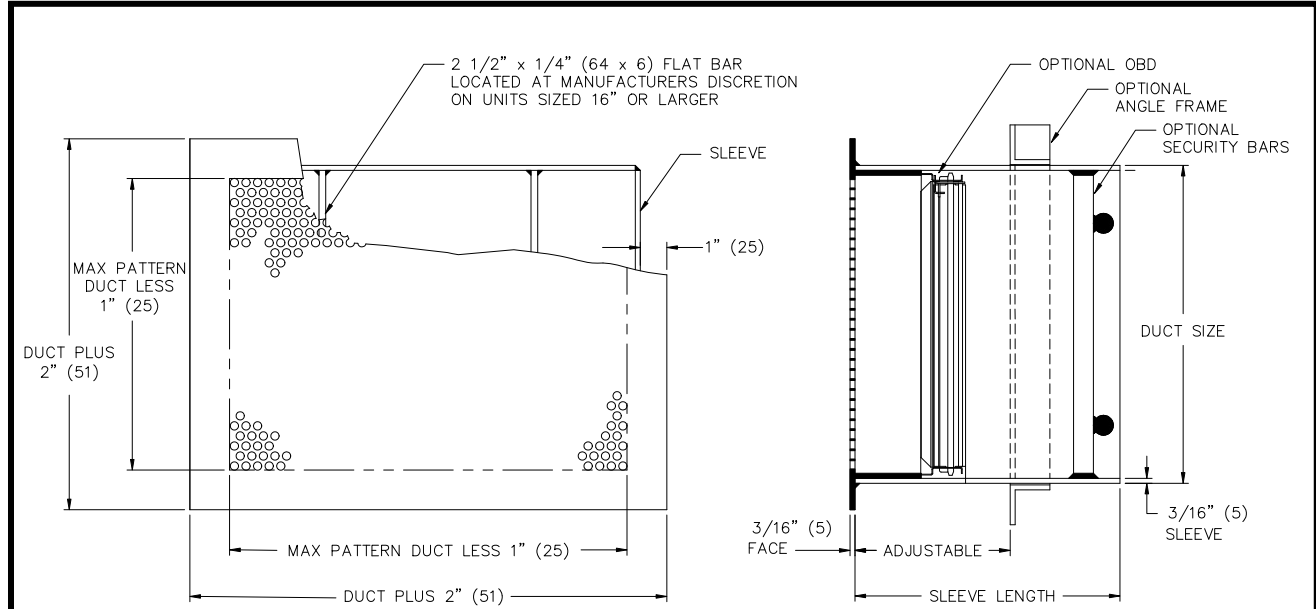

FACE VIEW

CROSS SECTION

STANDARD FEATURES :

1. **FACE PLATE** : 3/16" (5) steel with 5/16" (8) round holes on 7/16" (11) staggered centers.
2. **SLEEVE** : 3/16" (5) stitch welded seams.
3. All welded construction.
4. **FINISH** : 44 British white.
5. **SIZES** : Available in 2" (51) increments only.*

DUCT MIN	6" (152) x 4" (102)
MAX	30" (762) x 30" (762)

*only odd size available is 9" x 9" (229 x 229)
6. **SLEEVE LENGTH** : Available in the following lengths only.

6" (152)	8" (203)	10" (254)
12" (305)	14" (356)	16" (406)
18" (457)		

OPTIONS : see FORM SG7050 for dimensional details

- Front or rear operated **OPPOSED BLADE DAMPER** is welded in place.
- 3/4" (19) Dai. **SECURITY BAR** grid is tack welded twice at each intersection and welded completely around at the sleeve joint.
- ANGLE FRAME**, 1 1/2" x 1 1/2" x 3/16" (38x38x5) welded at corners, ships unpainted and loose for field installation.
- ANCHOR BARS** 3/4" (19) DIA x 3" (76) long are welded around at the sleeve joint. (not shown here - see FORM SG7050)

RECOMMENDED OPENING = DUCT SIZE + 1/2"

DIMENSIONS ARE GIVEN AS INCHES (MM).