

JOB NAME _____
 ARCHITECT _____
 ENGINEER _____
 CONTRACTOR _____
 LOCATION _____

SUBMITTALSHEET
 Form Number DS6044.1 Effective Date 10/99
 Replaces DS6044 & DS6043



6604FR / 6590FR SERIES

Adjustable Supply / Return with Round Neck & Perforated Face

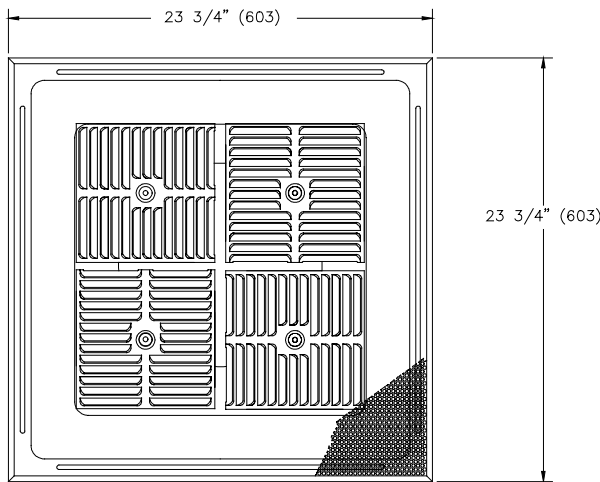

□ **6604FR - SUPPLY**

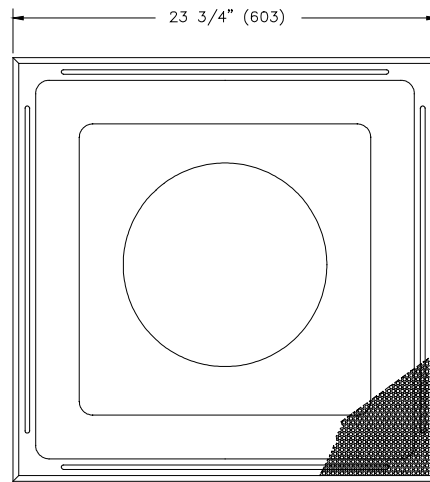

□ **6590FR - RETURN**

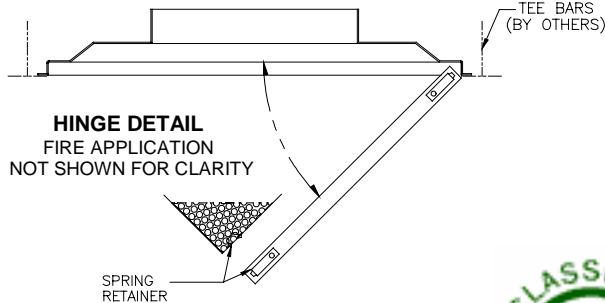

HINGE DETAIL
 FIRE APPLICATION
 NOT SHOWN FOR CLARITY

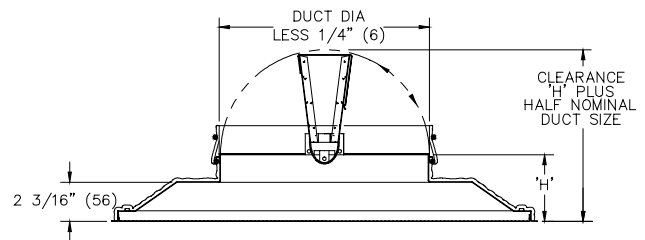

TYPICAL CROSS SECTION

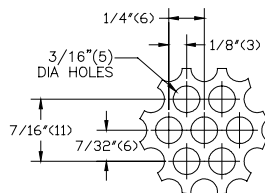

PERF DETAIL

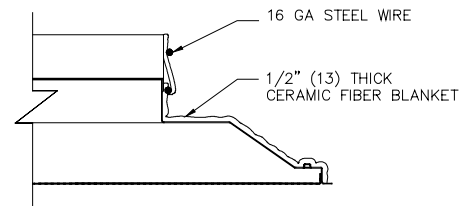

FIRE BLANKET DETAIL

- Series 6604F23 and 6590F23 feature a UL classified fire rated assembly that incorporates a 3 hour fire damper and 1/2" (13) thick ceramic fiber blanket.
- All steel construction
- Finish is 44 British White

DIMENSIONS ARE SHOWN AS
 INCHES (MM)

	INLET SIZE	'H'
NOMINAL PANEL 24 x 24 (610 x 610)	6 (152)	3 1/4" (83)
	8 (203)	
	10 (254)	3 3/4" (95)
	12 (305)	
	14 (356)	

Product Information is Subject to Change Without Notice