

JOB NAME _____
 ARCHITECT _____
 ENGINEER _____
 CONTRACTOR _____
 LOCATION _____

SUBMITTALSHEET
 Form Number DS6041.2 Effective Date 10/99
 Replaces DS6041.1 & DS6040.1



6404FR / 6290FR SERIES

Adjustable Supply / Return with Square Neck & Perforated Face

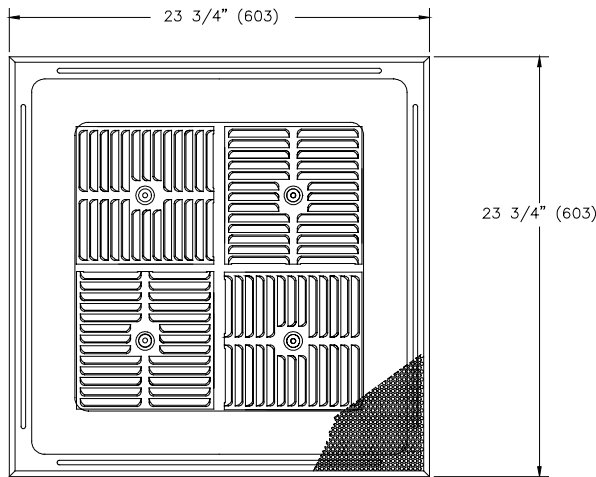

□ **6404FR - SUPPLY**

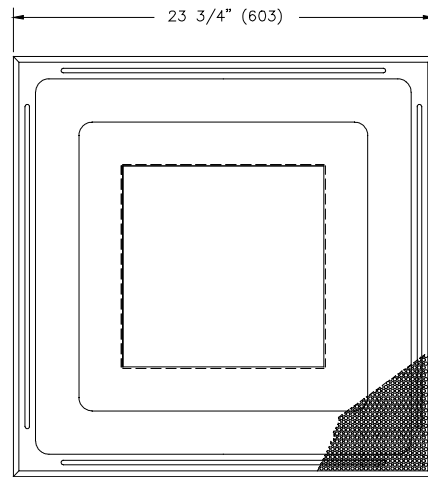

□ **6290FR - RETURN**

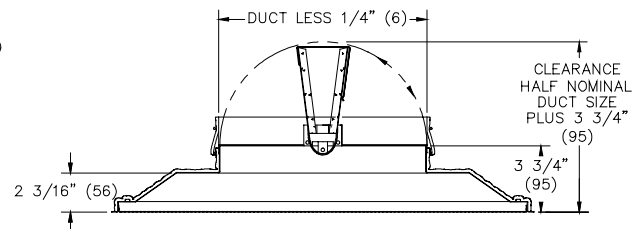
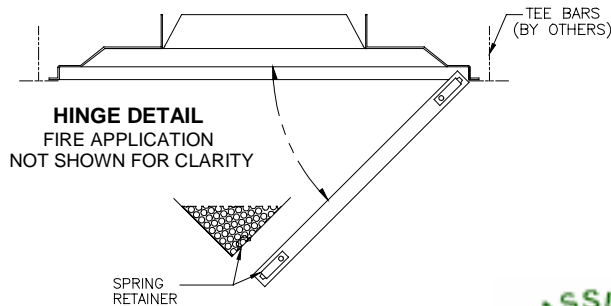

TYPICAL CROSS SECTION

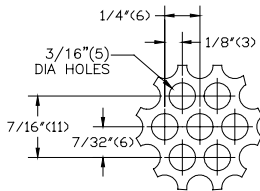

PERF DETAIL

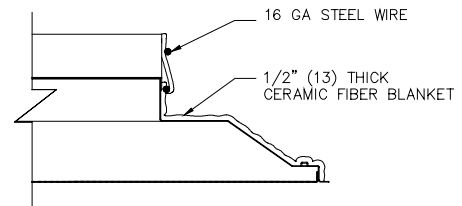

FIRE BLANKET DETAIL

- Series 6404F23 and 6290F23 feature a UL classified fire rated assembly that incorporates a 3 hour fire damper and 1/2" (13) thick ceramic fiber blanket.
- All steel construction
- Finish is 44 British White

DIMENSIONS ARE SHOWN AS
 INCHES (MM)

INLET SIZES AVAILABLE	NOMINAL PANEL 24 x 24 (610 x 610)
	6x6 (152x152)
	8x8 (203x203)
	10x10 (254x254)
	12x12 (305x305)
	14x14 (356x356)