

JOB NAME _____
 ARCHITECT _____
 ENGINEER _____
 CONTRACTOR _____
 LOCATION _____

SUBMITTAL SHEET
 Form Number DS6012.2 Effective Date 1/00
 Replaces DS6012.1



Series 6290F

Perforated Face Filter Return

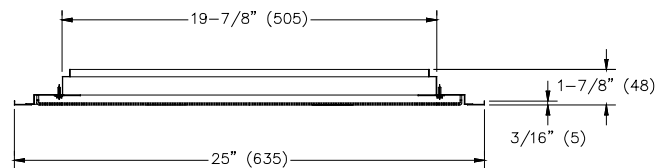
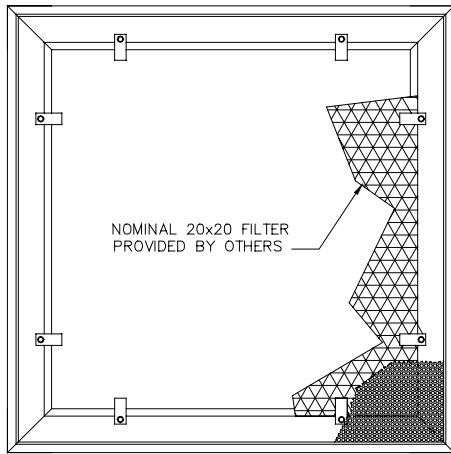

FRAME 20 CROSS SECTION

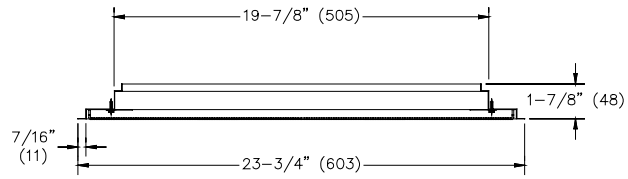

FRAME 23 CROSS SECTION

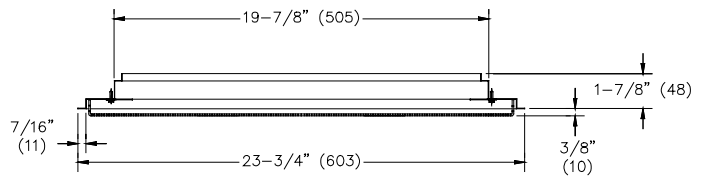

FRAME 30 CROSS SECTION

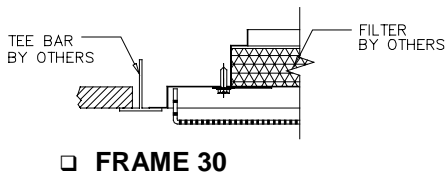
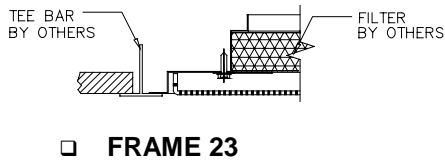
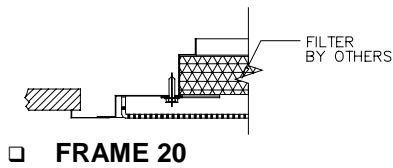

NOTES :

1. 6290F IS DESIGNED FOR STANDARD 1" FILTERS & FEATURES HINGED PERFORATED FACE FOR QUICK ACCESS TO THE FILTER FOR INSPECTION OR REPLACEMENT.
2. AVAILABLE IN 20x20 INLET SIZE ONLY FOR FRAME STYLES AS SHOWN.
3. STANDARD FINISH IS 44 WHITE

DIMENSIONS ARE GIVEN AS INCHES (MM)