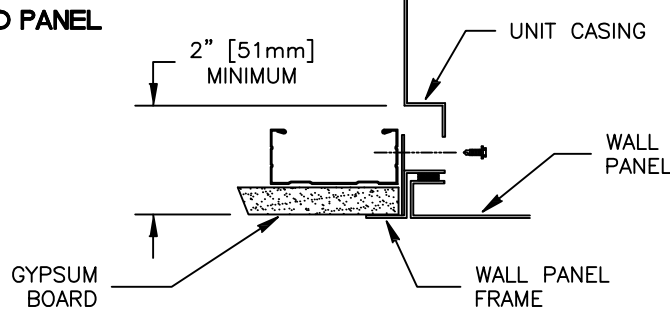
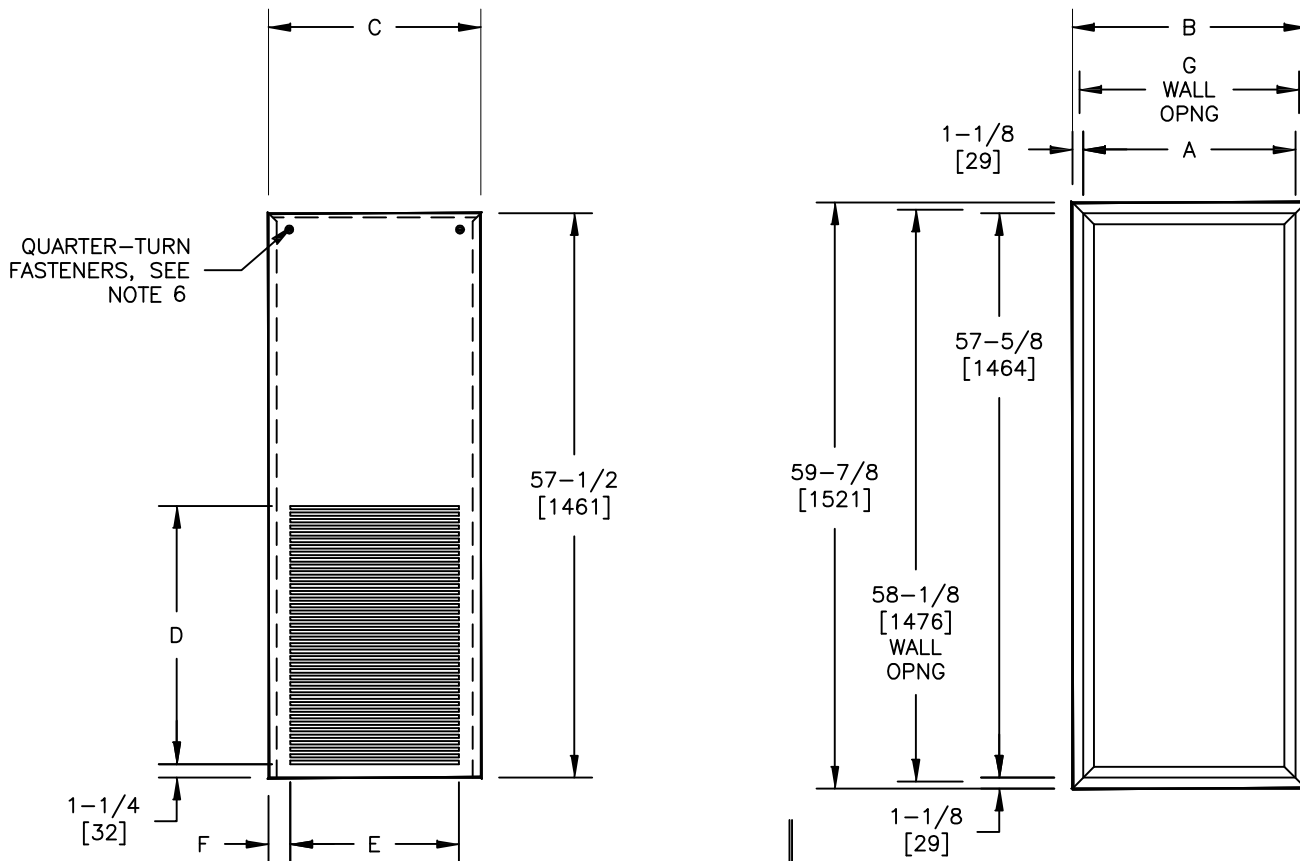

KVPH - VERTICAL STACK FAN COIL
 RECESSED WALL PANEL MODEL "KVPH" VERTICAL HIGH RISE FAN COIL UNIT

SUBMITTAL SHEET

INSTALLATION DETAIL
 (PARTIAL TOP VIEW)

UNIT SIZE	A	B	C	D	E	F	G
03/04	17-5/8 [448]	19-7/8 [505]	17-7/16 [443]	24-1/8 [613]	15 [381]	1-1/4 [32]	18-1/8 [460]
06/08	19-5/8 [498]	21-7/8 [556]	19-7/16 [494]	24-1/8 [613]	15 [381]	2-1/4 [57]	20-1/8 [511]
10/12	23-5/8 [600]	25-7/8 [657]	23-7/16 [595]	28-1/2 [724]	21 [533]	1-1/4 [32]	24-1/8 [613]

UNIT SIZE (6)	A	B	C	D	E	F	G
0306-0408	19-5/8 [498]	21-7/8 [556]	19-7/16 [494]	24-1/8 [613]	15 [381]	2-1/4 [57]	20-1/8 [511]
0310-0412	23-5/8 [600]	25-7/8 [657]	23-7/16 [595]	24-1/8 [613]	21 [533]	1-1/4 [32]	24-1/8 [613]
0610-0812	23-5/8 [600]	25-7/8 [657]	23-7/16 [595]	24-1/8 [613]	21 [533]	1-1/4 [32]	24-1/8 [613]

- NOTES:
- ALL DIMENSIONS ARE INCHES [MM]. METRIC VALUES ARE SOFT CONVERSION.
 - ALL DIMENSIONS ARE ±1/4" [6MM].
 - FINISHED WALL SURFACE MUST BE FURRED OUT A MINIMUM OF 2" [51MM] FROM FRONT OF UNIT.
 - STANDARD FINISH IS POWDER COAT BAKED ENAMEL. COLOR IS "PEARL WHITE SATIN".
 - SIZES SHOWN ARE FOR "UP-SIZED" CABINET UNITS USED IN "ENVIRD-PAC" PAIRS.
 - MOUNTING HARDWARE IS FACTORY INSTALLED. REFER TO INSTRUCTIONAL DRAWING "FCS05-KVPE_KVPP_KVPS_02" FOR DETAILS.

Revision Date: 04/15	Form: FCS05-KVPH07	Replaces: NEW
----------------------	--------------------	---------------