

UNIT SIZE	DIMENSIONS	
	A	B
02	36 1/4" (921)	17 1/4" (438)
03	39 1/2" (1003)	20 1/2" (521)
04	44 1/2" (1130)	25 1/2" (648)
06	51 1/4" (1302)	32 1/4" (819)
08	58 1/4" (1480)	39 1/4" (997)
09	62 1/2" (1588)	43 1/2" (1105)
10	72 1/4" (1835)	53 1/4" (1353)
12	80 1/4" (2038)	61 1/4" (1556)

NOTE:

1. All dimensions are inches (millimeters). All dimensions $\pm 1/4"$ (6mm). Metric values are soft conversions.
2. Left hand unit shown, right hand unit opposite.
3. Provide sufficient clearance to access electrical controls and comply with applicable codes and ordinances.
4. Drain piping should be routed through casing opening indicated to provide proper slope.
5. Bottom panel removable for access to filter and fan assembly.
6. Corner panels are removable to access electrical enclosure, coil and valve pack.
7. Internal insulation of field piping may be required.
8. Field piping casing penetrations must be cut in the field to match individual job requirements.
9. All dimensions also apply to units with Electric Heat Only.

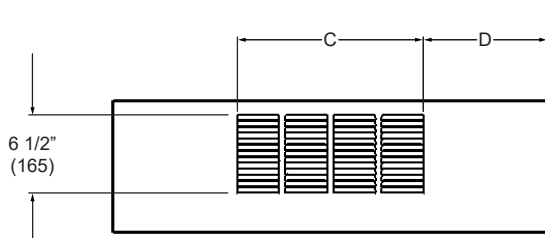

**FRONT PANEL
LOUVERED SUPPLY**

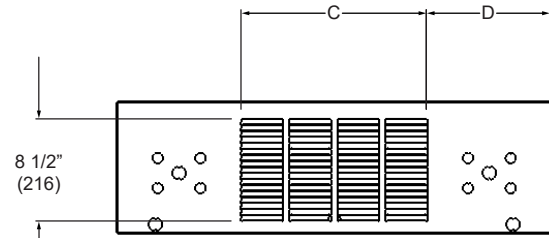

**BACK PANEL
LOUVERED RETURN**

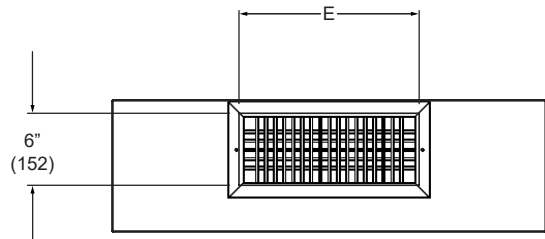

**FRONT PANEL
DOUBLE DEFLECTION DISCHARGE GRILLE**

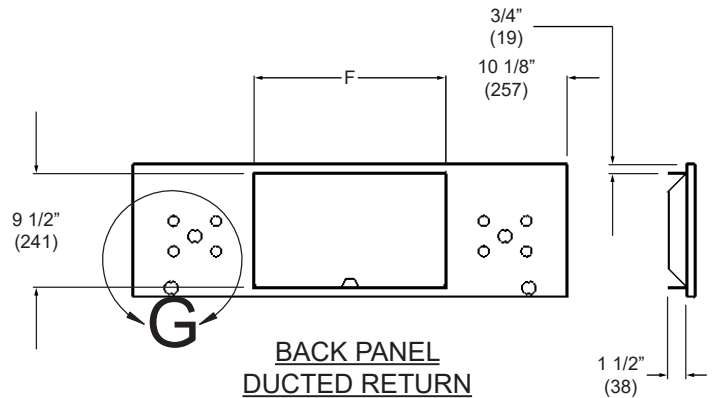

**BACK PANEL
DUCTED RETURN**

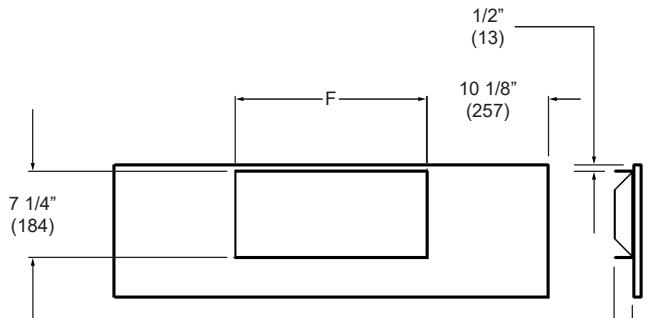

**FRONT PANEL
DUCTED SUPPLY**

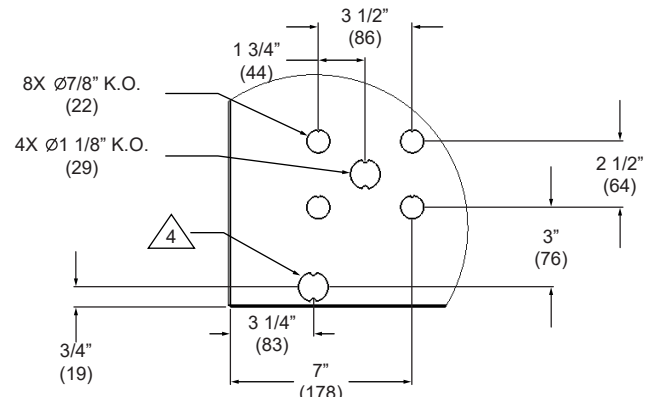

DETAIL G

DIMENSIONS				
UNIT SIZE	C	D	E	F
02	15 1/2" (394)	10 3/8" (264)	15" (381)	16" (406)
03	15 1/2" (394)	12" (305)	18" (457)	19 1/4" (489)
04	23 1/2" (597)	10 1/2" (267)	23" (584)	24 1/4" (616)
06	27 1/2" (699)	11 7/8" (302)	30" (762)	31" (787)
08	35 1/2" (902)	11 3/8" (289)	37" (940)	38" (965)
09	39 1/2" (1003)	11 1/2" (292)	41" (1041)	42 1/4" (1073)
10	51 1/2" (1308)	10 3/8" (264)	23" (584)	52" (1321)
12	59 1/2" (1511)	10 3/8" (264)	27" (686)	60" (1524)

NOTE:

- All dimensions are inches (millimeters). All dimensions $\pm 1/4"$ (6mm). Metric values are soft conversions.
- Left hand unit shown, right hand unit opposite.
- Provide sufficient clearance to access electrical controls and comply with applicable codes and ordinances.
- Drain piping should be routed through casing opening indicated to provide proper slope.
- Bottom panel removable for access to filter and fan assembly.
- Corner panels are removable to access electrical enclosure, coil and valve pack.
- Internal insulation of field piping may be required.
- Field piping casing penetrations must be cut in the field to match individual job requirements.
- All dimensions also apply to units with Electric Heat Only.