

JOB NAME \_\_\_\_\_  
 ARCHITECT \_\_\_\_\_  
 ENGINEER \_\_\_\_\_  
 CONTRACTOR \_\_\_\_\_  
 LOCATION \_\_\_\_\_

**SUBMITTAL SHEET**  
 Form Number TUS304.9 Effective Date 07/20  
 Replaces TUS304.8

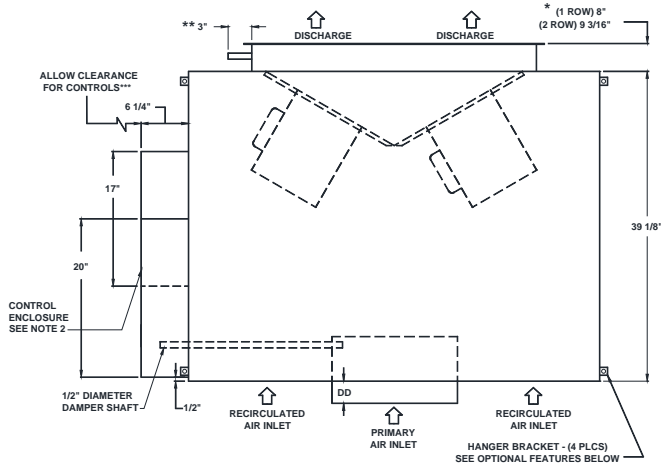

**QFC Unit Size 7**  
**HOT WATER HEAT CONSTANT VOLUME FAN TERMINAL UNIT**



**PLAN VIEW – LEFT HAND CONTROL & COIL CONNECTION**  
 CONTROLS AND SENSORS NOT SHOWN

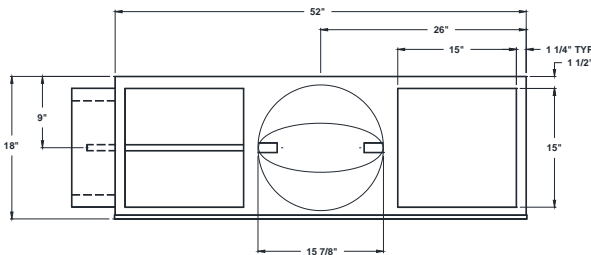

**INLET VIEW**

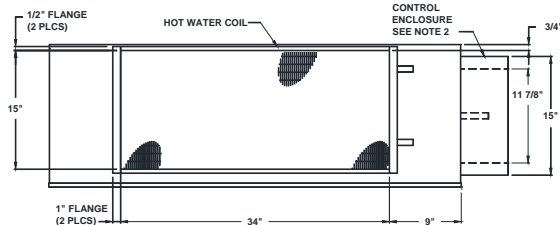

**DISCHARGE VIEW**

UNIT SIZE	INLET SIZE	PSC HP	ECM HP
7	16	3/4 (2)	1 (2)

**STANDARD FEATURES:**

- 20 Ga. galvanized steel construction
- Control enclosure provided for electronic components
- 1/2" thick dual density fiberglass insulation meeting **NFPA 90A** and **UL 181** safety requirements
- Field adjustable fan speed control
- Two 3/4HP □ 208V/240V □ 277V multi-voltage, single speed, single phase, permanently lubricated PSC motors
- Factory mounted, 1 or 2 row hot water coil with 5/8" O.D. connection, 1/2" O.D. copper tubes, 20 Ga. steel casing, & aluminum fins; 10 FPI
- Removable bottom panel allows easy access to all internal components for maintenance
- Four quadrant averaging cross flow sensor (DD=6 7/8")
- Flanged discharge connection on hot water coil
- 24 volt control transformer for electronic controls
- **ETL** listed; **AHRI** certified sound ratings

**OPTIONAL FEATURES:**

- Two 1HP ECM Motors
  - Manual Control
  - 0-10Vdc Remote Control
  - 2-10Vdc Remote Control
  - 208V/240V
  - 277V
- Liners:
  - 1" dual density fiberglass insulation
  - 1/2" Foil encapsulated fiberglass insulation
  - 1" Foil encapsulated fiberglass insulation
  - 1/2" Cellular insulation
  - 1" Cellular insulation
- Coil Connections:
  - Left Hand
  - Right Hand
- Control Enclosure Location:
  - Left Hand
  - Right Hand
- Dust tight control enclosure
- Linear averaging flow sensor (DD = 6 7/8")
- Hanger brackets
- Motor fusing
- Motor disconnect
- Induced air inlet attenuator
- Induced air filter, construction type, 17"x17"x1" (qty 2)
- Coil access door upstream of coil
- Coil vent and drain

**NOTE:**

1. Dimensions are given in inches
2. Digital or Analog control enclosure is 20" x 11 7/8" Pneumatic 17" x 15"
3. Discharge outlet dimensions : 34" x 15"

\* 12" depth for all 1 and 2 row hot water coils with access doors

\*\* 6 1/16" long connection with vent and drain

\*\*\* Check NEC for unit clearance requirements