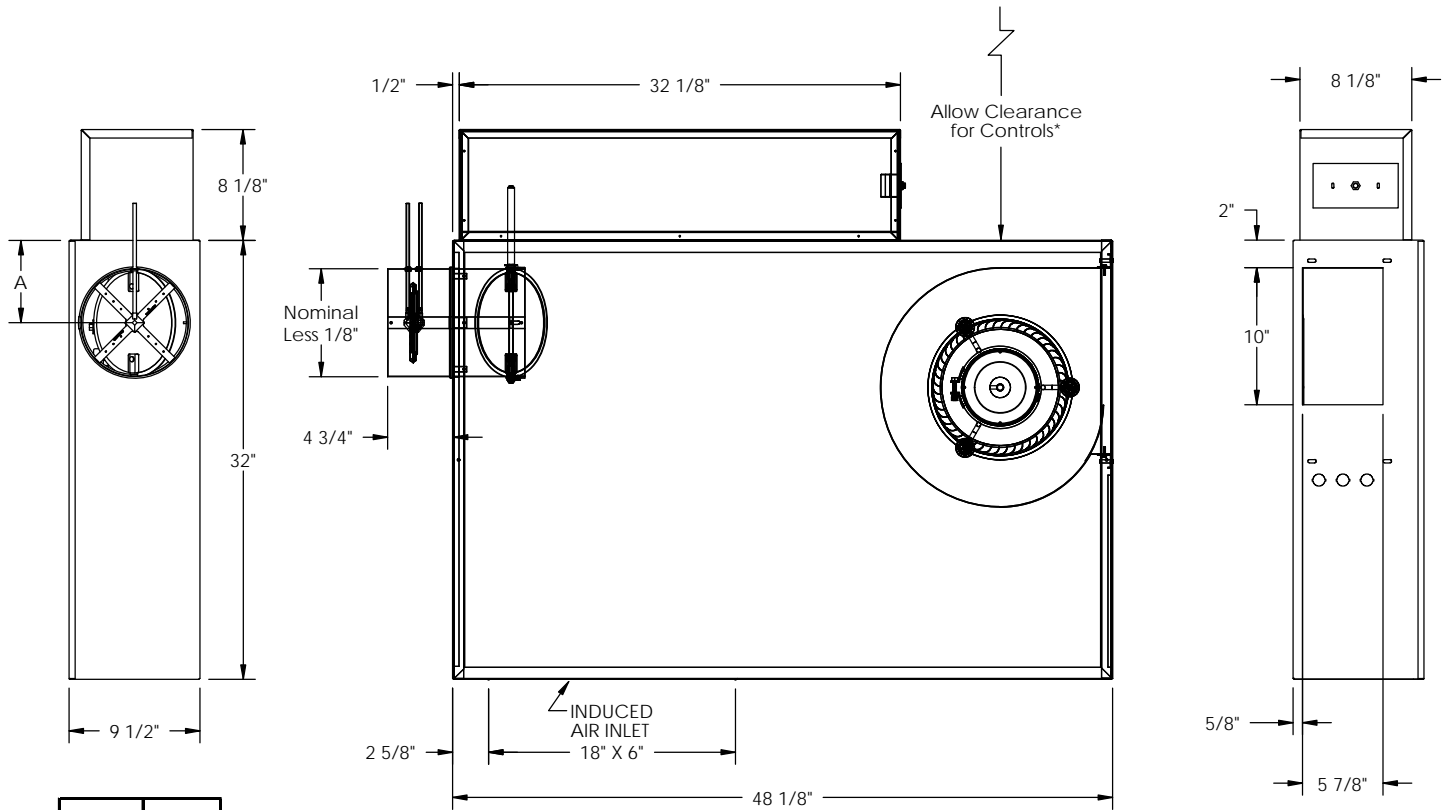

KLPS Unit 2
Cooling Only with Electronic Controls
SUBMITTAL SHEET

Inlet Size	A
06	5"
08	6"

INLET VIEW
PLAN VIEW - LEFT HAND UNIT
DISCHARGE VIEW
STANDARD FEATURES:

- 20GA. Galvanized Steel Construction
- Steel Control Enclosure for Electronic Components
- 1/2" Thick Dual Density Fiberglass Insulation Meeting NFPA 90A and UL181 Safety Requirements
- 1/3 HP ECM Motor with Permanently Lubricated Ball Bearings and Constant Airflow Program.
 - Manual Control
 - 0-10Vdc Remote Control
 - 2-10Vdc Remote Control
 - 120V
 - 208/240V
 - 277V
- Field Adjustable Speed Controller
- Bottom Access Panel for Service
- 4 Quadrant, Center Averaging Inlet Flow Sensor
- Factory Supplied 24 Volt Control Transformer for Electronic Controls
- ETL Listed
- Performance Data per AHRI Standard 880
- Variety of Direct Digital or Analog Electronic Control Packages Available

* Check NEC for Unit Clearance Requirements

OPTIONAL FEATURES:

- Liners
 - 1/2" Cellular Insulation
 - 1/2" Foil Encapsulated Fiberglass Insulation
 - No Liner
- Left Hand Controls
- Right Hand Controls
- Motor Toggle Disconnect Switch
- Motor Fusing
- Dust Tight Control Enclosure
- Hanger Brackets
- Linear Averaging Inlet Flow Sensor
- Construction Type Air Filter – 19" x 8 5/8" x 1"
- Merv Type 8 Air Filter – 19" x 8 5/8" x 1"
- Dual Access Panels for Service
- Cam-Locks (Dual Access Panel Only)