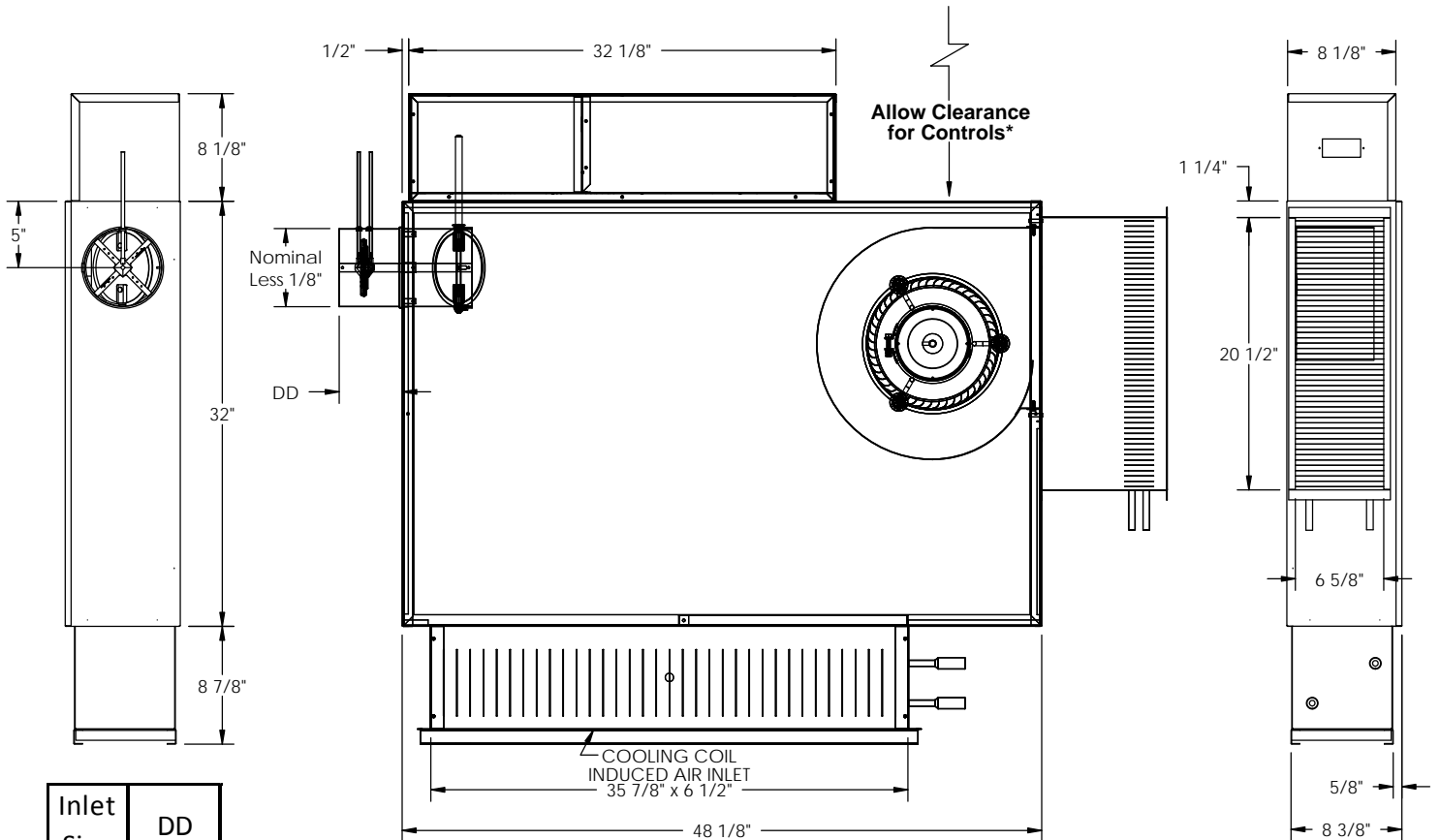

KLPS-D Unit Size 1
Hot Water with Electronic Controls
SUBMITTAL SHEET

Inlet Size	DD
04"	6 3/4"
05"	6 3/4"
06"	4 3/4"
07"	4 3/4"

PLAN VIEW - LEFT HAND UNIT
 (Downstream Side Induced Coil Connection Shown)

INLET VIEW

DISCHARGE VIEW

STANDARD FEATURES:

- 20GA. Galvanized Steel Construction
- Steel Control Enclosure for Electronic Components
- 1/2" Thick Dual Density Fiberglass Insulation Meeting NFPA 90A and UL181 Safety Requirements
- 1/3 HP ECM Motor with Permanently Lubricated Ball Bearings and Constant Airflow Program
 - Manual Control 0-10Vdc Remote Control
 - 2-10Vdc Remote Control
 - 120V 208/240V 277V
- Bottom Access Panel for Service
- Sensible Cooling Coil Factory Installed on Induced Air Inlet Supplied with Drip Tray **
- 4 Quadrant, Center Averaging Inlet Flow Sensor
- Factory Supplied 24 Volt Control Transformer for Electronic Controls
- ETL Listed
- Performance Data per AHRI Standard 880
- Construction Type Air Filter – 19" x 7 1/2" x 1" x 2

OPTIONAL FEATURES:

- Liners
 - 1/2" Cellular Insulation
 - 1/2" Foil Encapsulated Fiberglass Insulation
 - No Liner
- Cooling Coil Connection
 - Left Hand Right Hand
- Cooling Coil Connection
 - Upstream Side Downstream Side
 - Left Hand Controls Right Hand Controls
 - Motor Toggle Disconnect Switch Motor Fusing
 - Dust Tight Control Enclosure Hanger Brackets
 - Linear Averaging Inlet Flow Sensor
 - Merv Type 8 Air Filter – 19" x 7 1/2" x 1" x 2
 - Dual Access Panels for Service
 - Cam-Locks (Dual Access Panel Only)

* Check NEC for Unit Clearance Requirements
 ** See Submittal Form TUS-03-135-000CP